



HARAYA

RESIDENCES

Product Presentation
January 2023



A Vertical Gated Village for the Modern Era

Haraya Residences is a vertical gated village located in the heart of Bridgetowne Destination Estate, featuring a collection of 558 beautifully appointed residences in the South Tower and more forthcoming in the North Tower.

Cosmopolitan Living Reimagined

Surrounded by some of the most prestigious gated communities in Metro Manila and located at the very heart of Bridgetowne Destination Estate, a new mixed-use township in Pasig –Haraya Residences offers a unique balance of convenience and privacy.

Discover the finest shopping and dining experiences at your fingertips—no matter your preference, options abound.



Places



MAJOR COMMERCIAL CENTERS

- 1 - Shang Central (4 km)
- 2 - Ayala Malls The 30th (3 km)
- 3 - Eastwood City (3 km)
- 4 - Robinsons Galleria (3 km)
- 5 - The Podium (3 km)
- 6 - Greenhills Center (4 km)
- 7 - SM Megamall (4 km)

TOP MEDICAL INSTITUTIONS

- 8 - The Medical City (3 km)
- 9 - Cardinal Santos Medical Center (5 km)
- 10 - St. Luke's Medical Center-Global City (9 km)
- 11 - Makati Medical Center (13 km)

ACADEMIC INSTITUTIONS

- 12 - Saint Paul College, Pasig (3 km)
- 13 - Saint Pedro Poveda College (3 km)
- 14 - University of Asia and the Pacific (4 km)
- 15 - Xavier School (4 km)
- 16 - La Salle Greenhills (4 km)
- 17 - Ateneo de Manila University (6 km)
- 18 - Reedley International School (6 km)
- 19 - Immaculate Conception Academy (6 km)
- 20 - Lourdes School of Mandaluyong (6 km)
- 21 - Miriam College (7 km)
- 22 - The British School Manila (7 km)
- 23 - Life Academy International (8 km)
- 24 - Everest Academy Manila (8 km)
- 25 - International School Manila (8 km)
- 26 - Chinese International School (9 km)
- 27 - University of the Philippines Diliman (12 km)

CORPORATE HEADQUARTERS

- 28 - Asian Development Bank (3 km)
- 29 - BDO Corporate Center (3 km)
- 30 - Meralco (3 km)
- 31 - UnionBank of the Philippines (3 km)
- 32 - Jollibee Corporation (4 km)
- 33 - San Miguel Corporation (5 km)
- 34 - Unilab (5 km)
- 35 - Petron Corporation (6 km)

AIRPORTS

- 36 - NAIA Terminal 3 (17 km)
- 37 - NAIA Terminal 2 (19 km)
- 38 - NAIA Terminal 1 (20 km)



● Residential Area

- Acropolis
- Circulo Verde
- Corinthian Gardens
- Corinthian Hills
- Greenmeadows
- The Grove
- Valle Verde
- White Plains

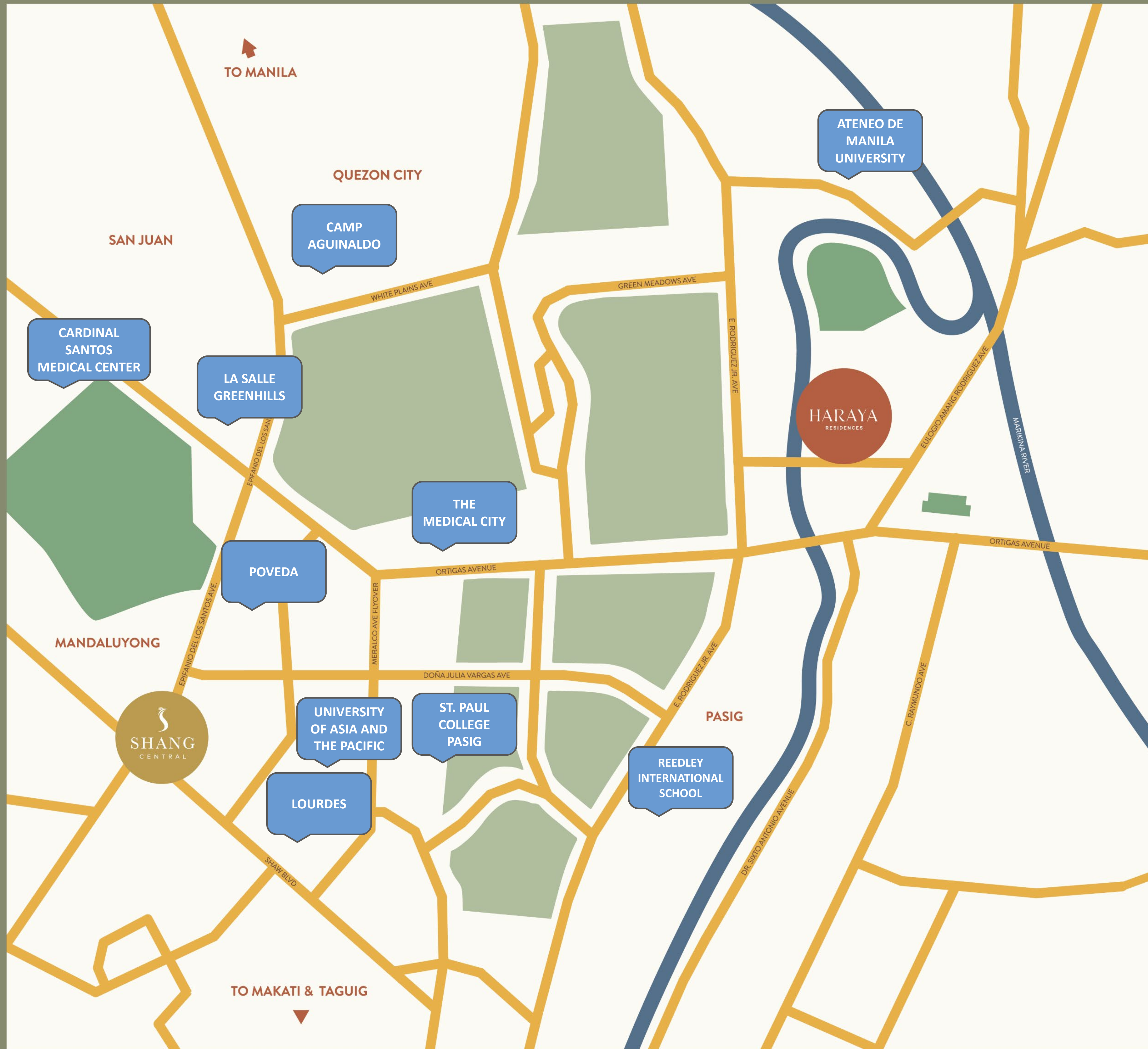

- Key Institutions

Academic Institutions

- Ateneo De Manila University
- University of the Philippines
- University of Asia and the Pacific
- Miriam College
- La Salle Greenhills
- St. Paul College Pasig
- Lourdes School of Mandaluyong
- Reedley International School

Medical Institutions

- The Medical City
- Cardinal Santos Medical Center



● Commercial Area

- Shangri-La Plaza
- Arcovia
- Eastwood City
- Estancia at Capitol Commons
- Robinsons Galleria
- SM Megamall
- The Grove
- Ayala Malls 30th
- Tiendesitas



Building Features

Features Summary

57	Number of residential floors
558	Number of units
702	Number of carparks
6	Passenger Lifts
1	Private lift (For 3-Bedroom)
1	Service lift
2270 SQM	Indoor amenities spaces
2500 SQM	Outdoor amenities spaces

Facilities

- 24-hour management services by Shang Properties Management Services Inc.
- Dedicated reception and concierge
- 24-hour security
- Intercom with link to reception lobby
- CCTV monitoring system at lobby, all lifts, and amenities floor
- Access card for residents
- RFID for vehicles
- Retail entrance via access card
- Centralized fire detection, alarm and protection system

A Dramatic Entrance

An exquisite balance of lush greenery and masterfully articulated details greet you at the entrance; an elegant design from the team of world-class architects and interior designers signifying that you have arrived.



*Artist's render for illustration purposes only.

The outdoor amenities of Haraya Residences offers over 2,500 square meters of thoughtfully designed outdoor amenities, featuring a variety of beautifully tended green spaces and private nooks. Unwind with the whole family in the swimming pools and children's play areas; decompress after a day at the office in the jacuzzi; rejuvenate with some outdoor yoga under the swaying trees.



*Artist's render for illustration purposes only.



Rediscover a Sense of Vibrancy

The amenities at Haraya Residences is the heart of the development—where privacy, community, and vibrant landscaping come together.

Amenities

Features Summary

BASEMENT

- Parking
- Carwash bay

GROUND FLOOR

- Concierge
- Mailroom
- Main lobby
- Lounge Area

AMENITY FLOOR (LEVEL 7)

- The Veranda
 - Indoor
 - Al Fresco
- The Tea Room
- The Studio
- The Playroom
- The Library
- The Lounge

AMENITY FLOOR (LEVEL 7 MEZZANINE)

- The Chef's Kitchen
- The Lobby Lounge
- The Game Room
- The Viewing Room
- The Gym
- Changing Rooms
- Sauna

THE LAWN (OUTDOOR AREA)

- Tropical Pool
- Kiddie Pool
- Jacuzzi
- Children's play area
- Outdoor lounge area
- Garden areas

Amenities Level 7

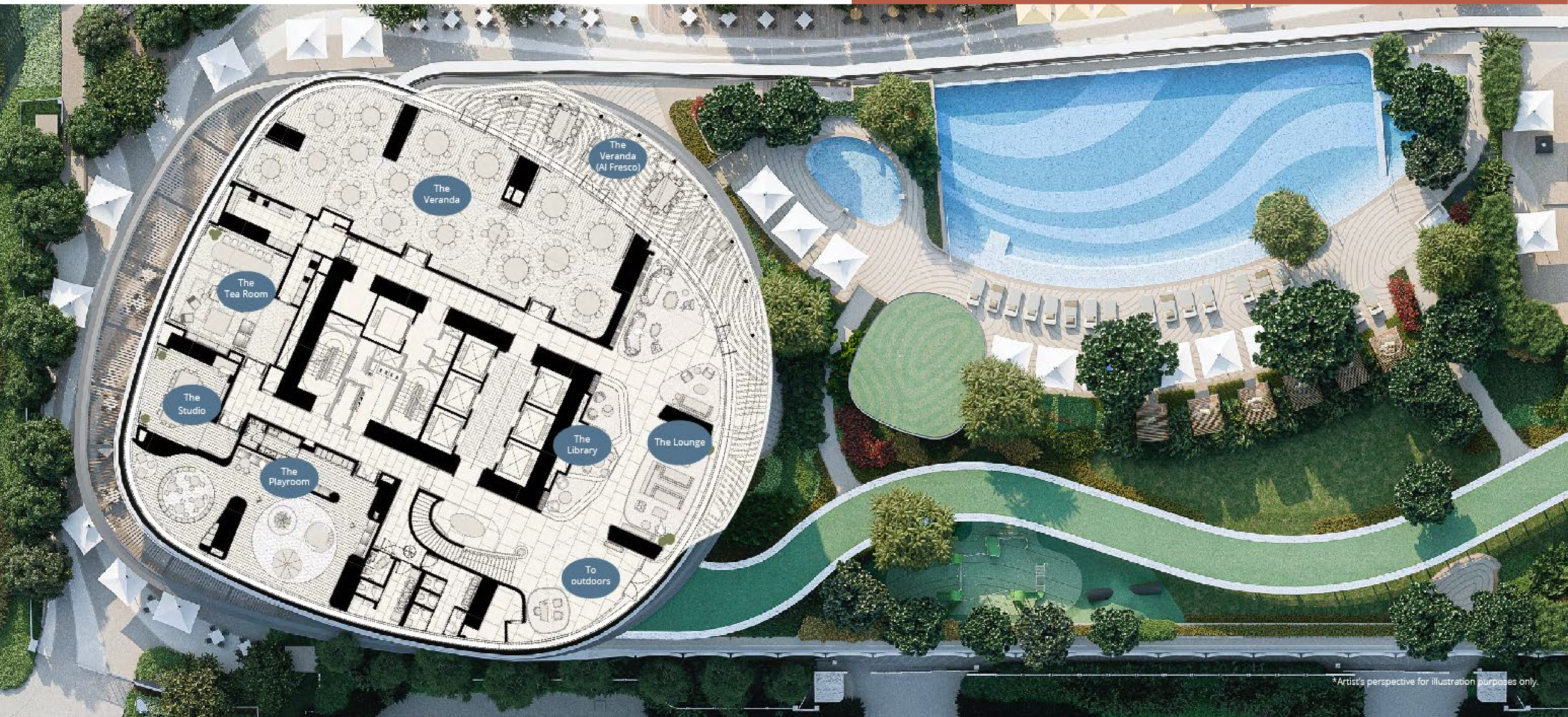

*Artist's perspective for illustration purposes only.

Amenities Level 7 Mezzanine

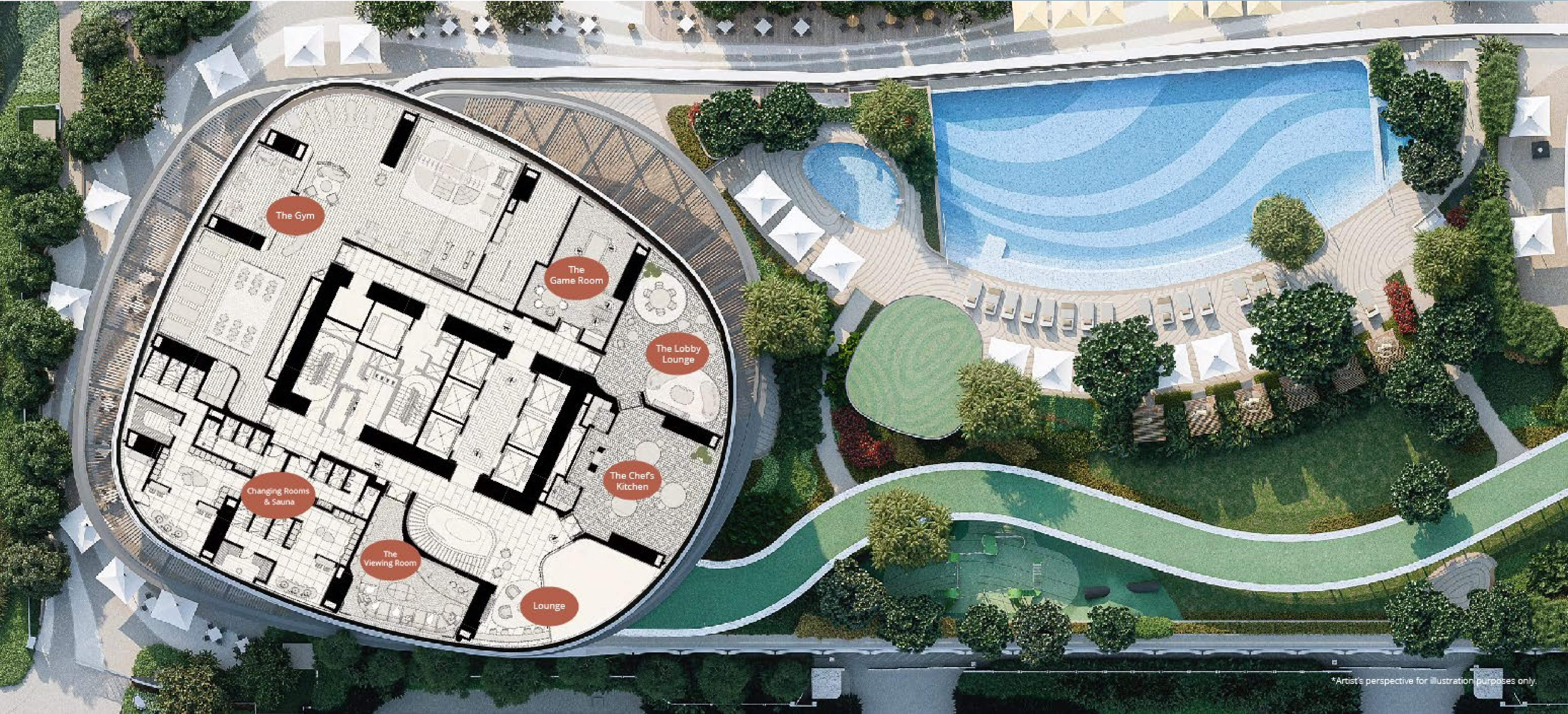

*Artist's perspective for illustration purposes only.



The Gym at Haraya Residences features a full suite of world-class fitness and wellness equipment in over 300 square meters of dedicated space at your doorstep. Whether you are just starting out or training for performance, keeping fit has never been more convenient.



Artists render for illustration purposes



Celebrate the important things in life. From a collection of unique venue spaces and lounges, to a private cinema, karaoke room, children's playroom, collaborative workspaces and more—There is 2,270 square meters of indoor amenities designed for you to make the most of your home.



*Artist's render for illustration purposes only.



Artist's render for illustration purposes only.

The Veranda

Celebrate at The Veranda with over 450 square meters of exquisitely designed function space with floor to ceiling windows and double doors that extends into the stunning gardens outside.



*Artist's render for illustration purposes only.

The Tea Room

The Tea Room is a beautifully appointed private room decorated with handcrafted furniture and artwork, ideal for more intimate gatherings or business meetings.



*Artist's render for illustration purposes only.

The Chef's Kitchen

Host an unforgettable private party for friends and family at Chef's Kitchen. Invite a private chef or roll up your sleeves and showcase your culinary skills in this cozy dining room featuring a fully-integrated pantry, hand-curated artwork, and exquisitely appointed furnishings.



*Artist's render for illustration purposes only.



*Artist's render for illustration purposes only.



*Artist's render for illustration purposes only.



*Artist's render for illustration purposes only.

The Lobby Lounge

The Lobby Lounge is Haraya Residences' largest lounge venue, featuring expansive floor to ceiling windows showcasing the stunning panoramic views of the skyline in a light-filled environment. A versatile space for both formal and informal occasions.



*Artist's render for illustration purposes only.

The Viewing Room

Enjoy a blockbuster or karaoke your heart out in The Viewing Room, a purpose-designed audio visual entertainment space perfect for celebrating with friends and family.



*Artist's render for illustration purposes only.

The Studio

Productivity at your fingertips. The Studio is a flexible and open creative space perfect for collaborative work or for hosting workshops and meetings.



Vibrant flora and verdant greens welcome you to The Grounds, the heart of the vertical gated village, designed for the whole family.

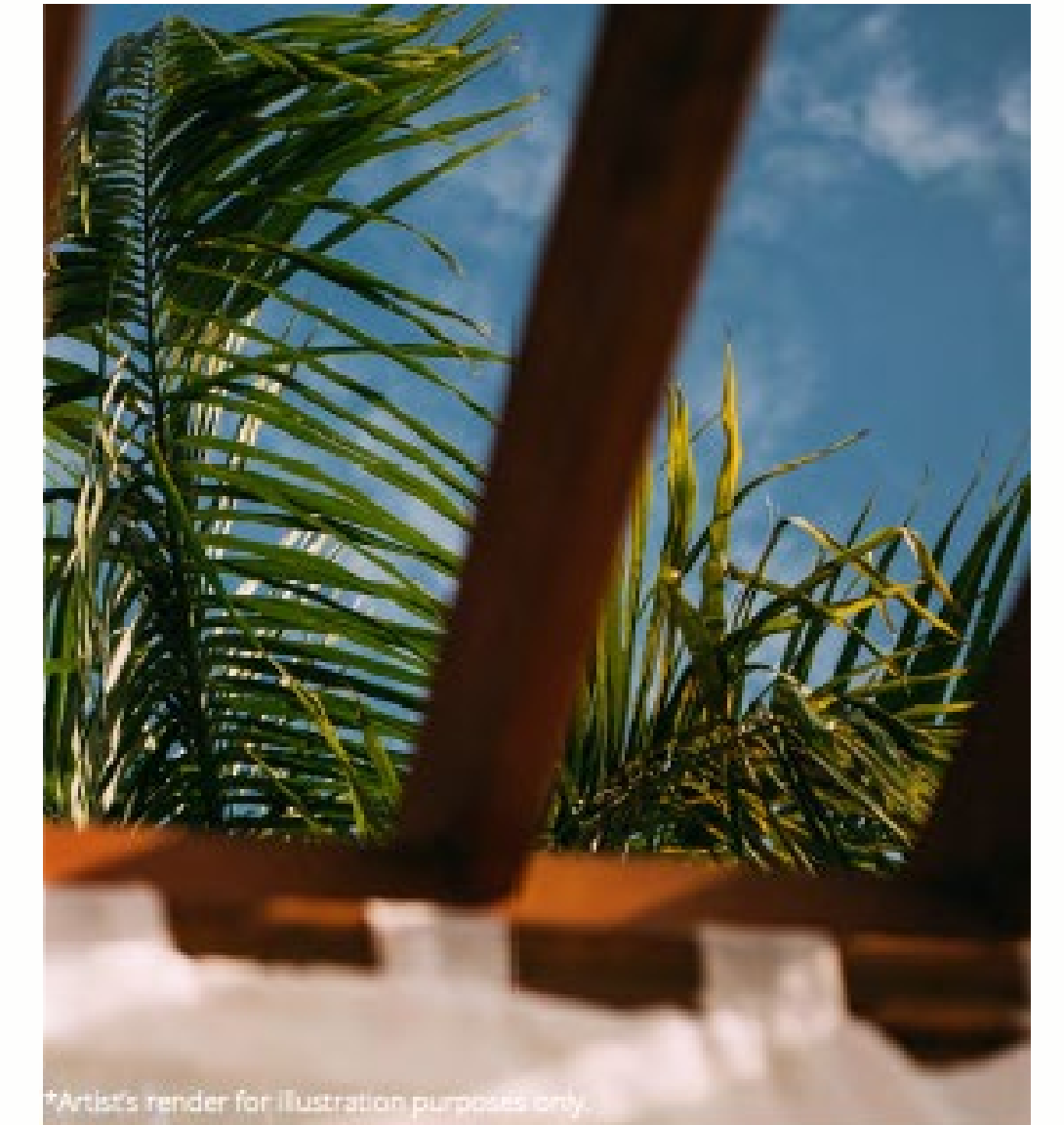

Artist's render for illustration purposes only.

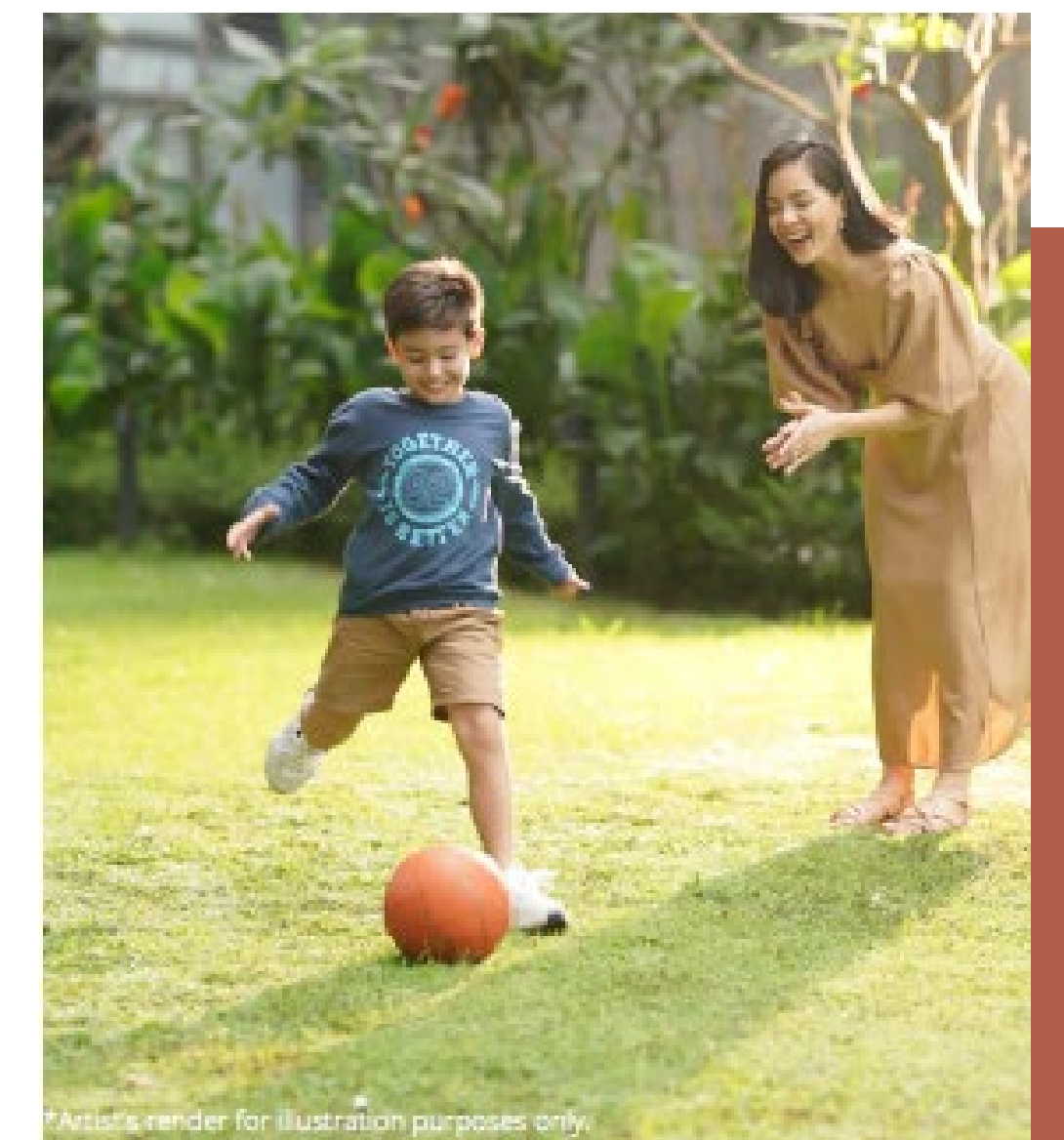

Artist's render for illustration purposes only.



Just as in a traditional gated village, Haraya Residences is designed to enkindle a sense of community in a safe, secure, and private environment.

Lounge by the pool, stroll through the lush grounds, and enjoy the many other amenities at Haraya Residences.



*Artist's render for illustration purposes only.



Step Outside Into the Heart of Your Home

Now more than ever, home is everything: a place where big plans are shared and lifelong memories made; a place for family and friends, for creativity and collaboration; a sanctuary to return to at the end of each day.

At Haraya Residences, our one-, two-, and three-bedroom suites reimagine the relationships between the interior and exterior experiences with lofty Italian-inspired loggias and sweeping new spatial configurations that expand the very notion of a home.

Welcome to Haraya Residences.

*Artist's render for illustration purposes only.

Unit Mix

Unit Types Summary

One-Bedroom	SQM Approx.	SQFT Approx.
A	68	731
B	62 - 63	667 - 678
C	60 - 61	645 - 656
D	66 - 67	710 - 721
F	86 - 87	925 - 936
I	63	678

Two-Bedroom	SQM Approx.	SQFT Approx.
E	139 - 140	1496 - 1506
H	107 - 108	1151 - 1162
J	141 - 142	1517 - 1528

Three-Bedroom	SQM Approx.	SQFT Approx.
G	186 - 187	2002 - 2012

Penthouse	SQM Approx.	SQFT Approx.
Penthouse A	497 - 507	5349 - 5457
Penthouse B	507 - 517	5457 - 5565



*Artist's render for illustration purposes only.

Unit Floorplans

The One-Bedroom Unit (A, B, C, D, F, I)

The One-Bedroom Unit reimagines the traditional one-bedroom layout with a studio den that offers additional space, and a loggia that expands the airy living room.

A curvilinear glass partition in the den provides privacy and flexibility when needed and unifies the living room into a home that is perfect for relaxing and entertaining alike.



*Artist's render for illustration purposes only.

Soft curves and generous use of glass partitions bridge the interior and exterior spaces, forming new patterns of circulation and new ways to experience life at home.



*Artist's render for illustration purposes only.



*Artist's render for illustration purposes only.



*Artist's render for illustration purposes only.



*Artist's render for illustration purposes only.

One-Bedroom A

Unit size (including loggia): approximately 68 sqm / 731 sqft
Loggia size: approximately 8 sqm / 86 sqft

- 1. Living Room
- 2. Dining Room
- 3. Master bedroom
- 4. Kitchen
- 5. Bathroom
- 6. Loggia

WD Washer - Dryer

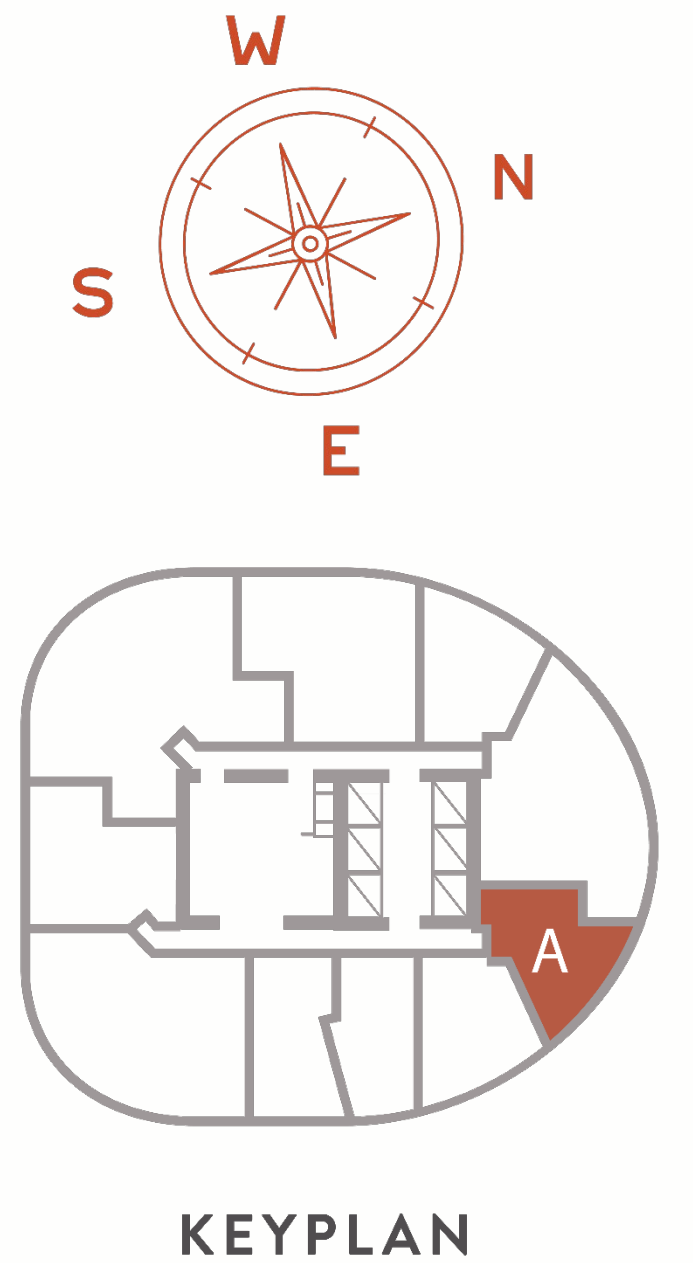

KEYPLAN

*Artist's perspective for illustration purposes only.

One-Bedroom B

Unit size (including loggia): approximately 62 - 63 sqm / 667 - 678 sqft
Loggia size: approximately 7 sqm / 75 sqft

- 1. Living Room
- 2. Dining Room
- 3. Master bedroom
- 4. Kitchen
- 5. Bathroom
- 6. Loggia

WD Washer - Dryer

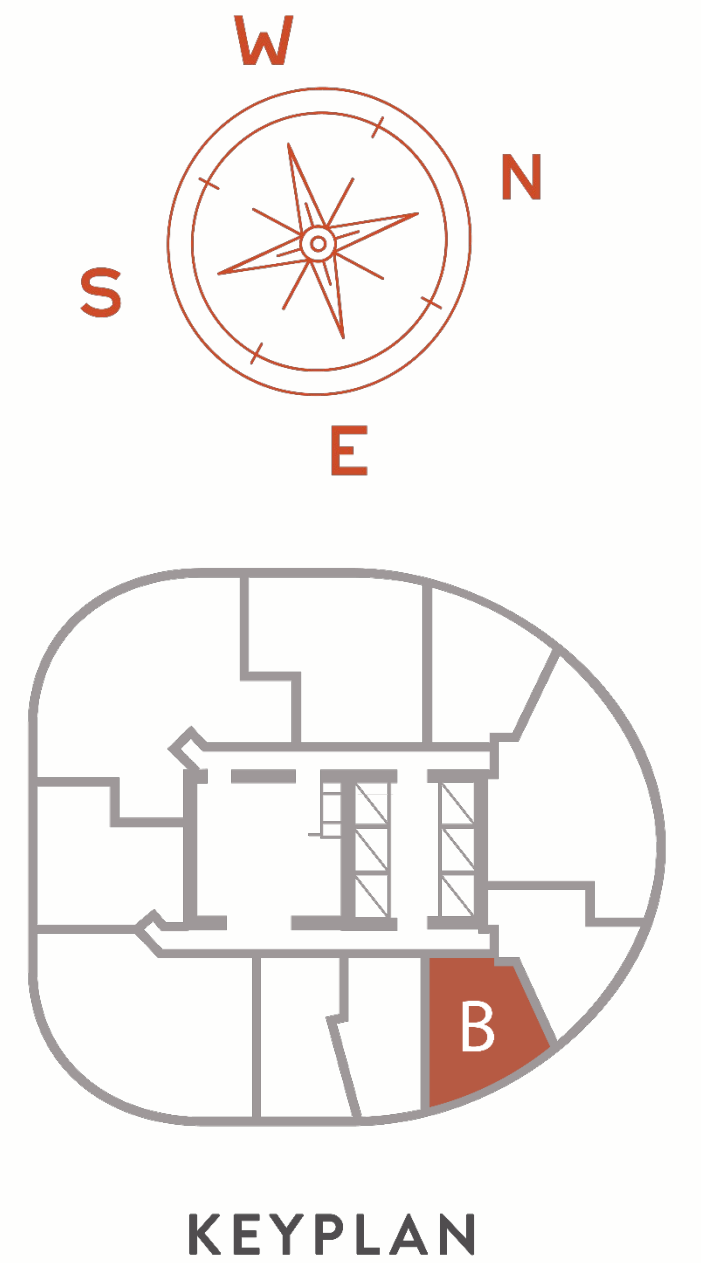

*Artist's perspective for illustration purposes only.

One-Bedroom C

Unit size (including loggia): approximately 60 - 61 sqm / 645 - 656 sqft
Loggia size: approximately 6 sqm / 64 sqft

1. Living Room
2. Dining Room
3. Master bedroom
4. Kitchen
5. Bathroom
6. Loggia

WD Washer - Dryer

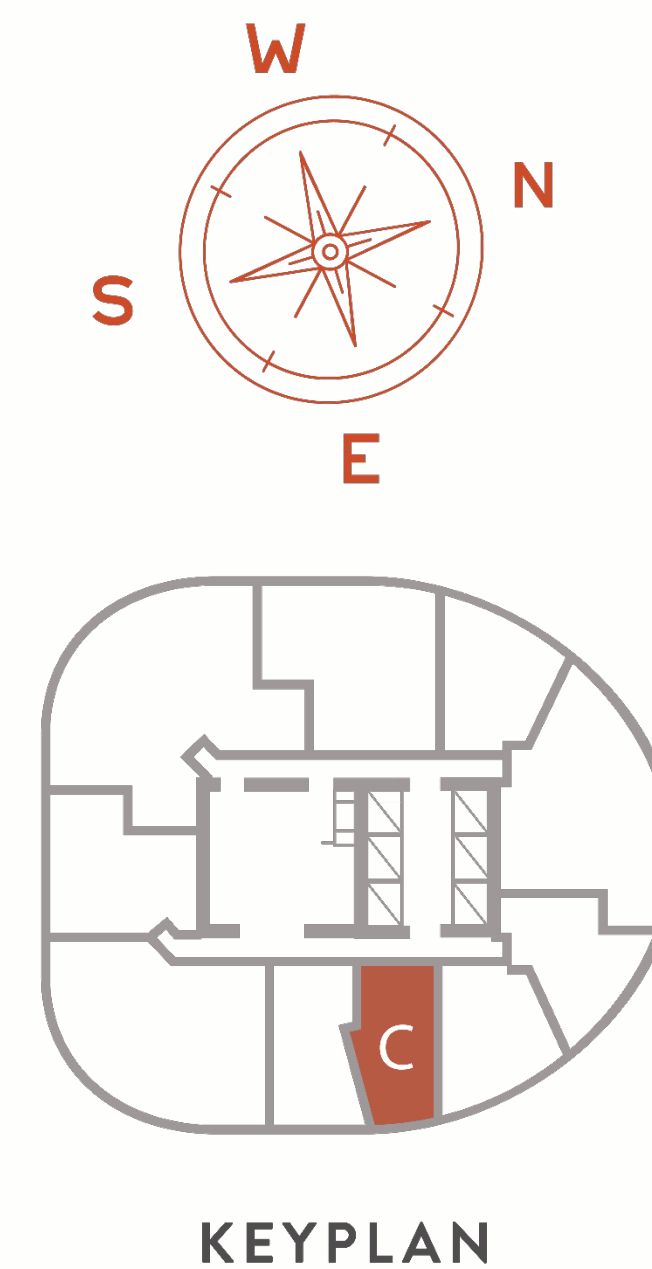

KEYPLAN

One-Bedroom D

Unit size (including loggia): approximately 66 - 67 sqm / 710 - 721 sqft
Loggia size: approximately 7 sqm / 75 sqft

- 1. Living Room
- 2. Dining Room
- 3. Master bedroom
- 4. Kitchen
- 5. Bathroom
- 6. Loggia

WD Washer - Dryer

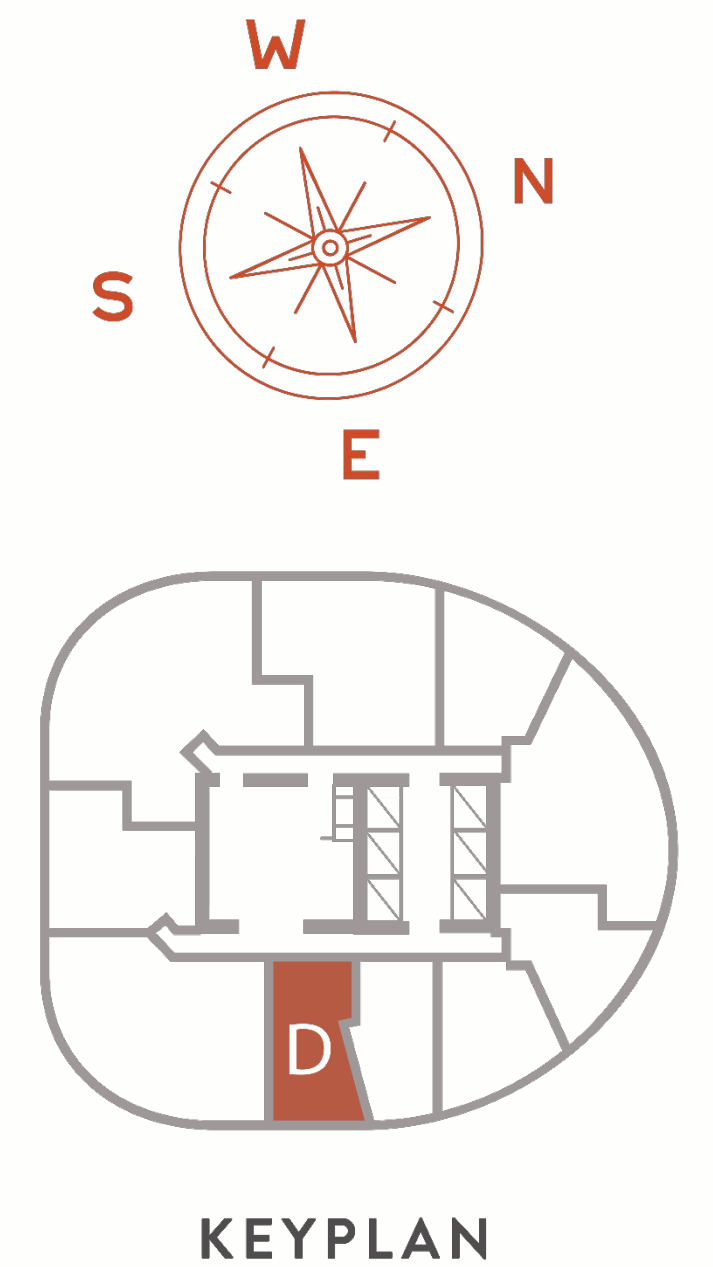

*Artist's perspective for illustration purposes only.

One-Bedroom F

Unit size (including loggia): approximately 86 - 87 sqm / 925 - 936 sqft
Loggia size: approximately 7 sqm / 75 sqft

- 1. Living Room
- 2. Dining Room
- 3. Master bedroom
- 4. Kitchen
- 5. Bathroom
- 6. Loggia

WD Washer - Dryer

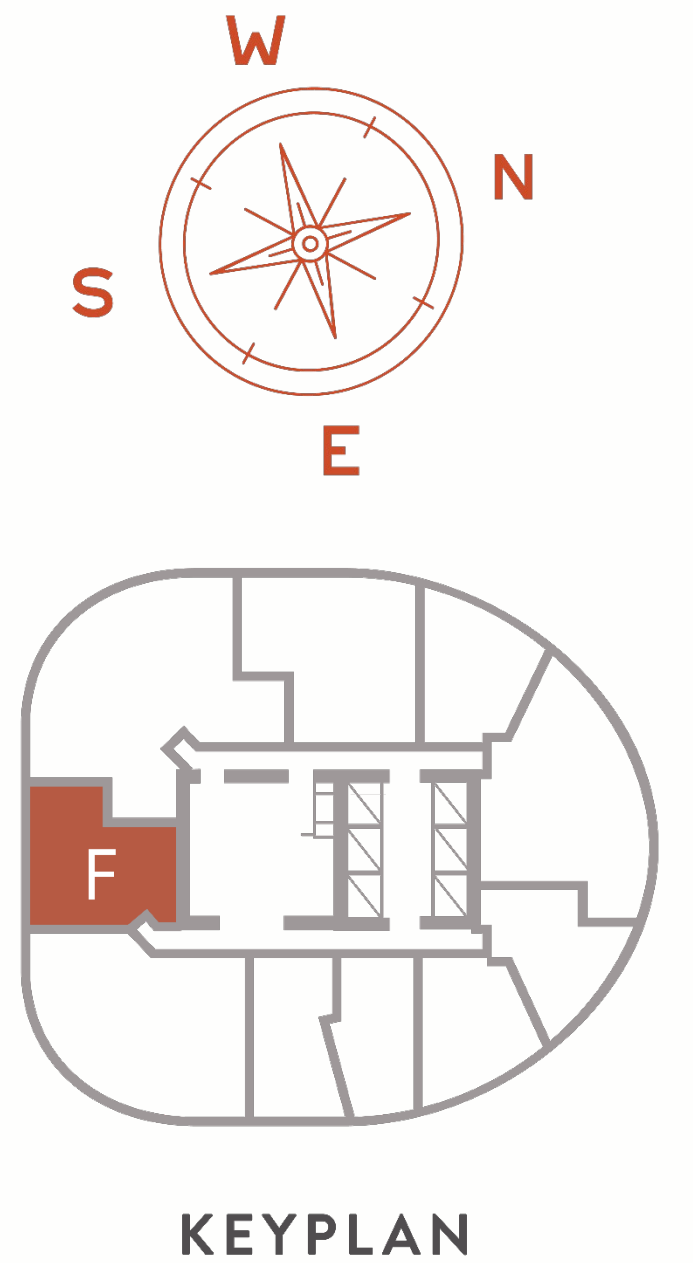

*Artist's perspective for illustration purposes only.

One-Bedroom I

Unit size (including loggia): approximately 63 sqm / 678 sqft
Loggia size: approximately 7 sqm / 75 sqft

- 1. Living Room
- 2. Dining Room
- 3. Master bedroom
- 4. Kitchen
- 5. Bathroom
- 6. Loggia

WD Washer - Dryer

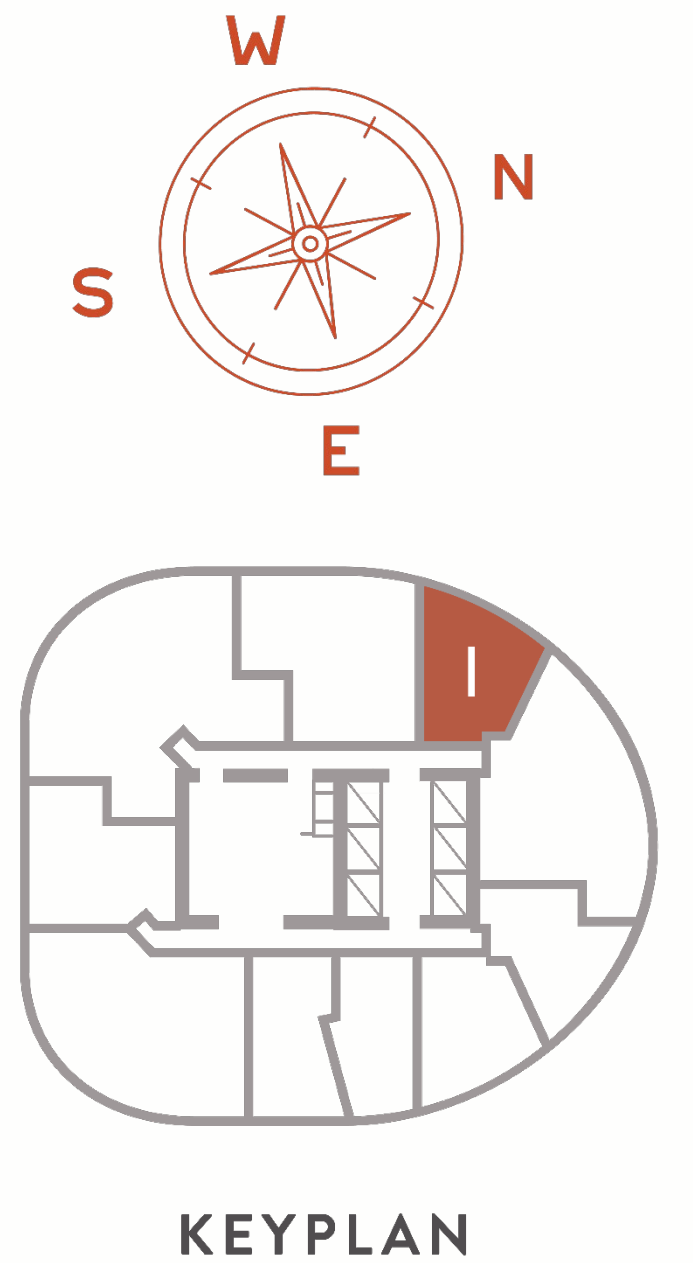

*Artist's perspective for illustration purposes only.

The Two-Bedroom Unit (E, H, J)

Designed for families and professionals alike, The Two-Bedroom Unit has expansive windows that extend from the lofty living room to the guest and master bedrooms, opening the home to sweeping panoramic views. The voluminous loggia is nestled between the dining and living areas, bridging the interior and exterior and creating a space that is airy and full of natural light.

Rediscover the loggia as a central component of cosmopolitan al fresco living, providing unique opportunities for entertaining and relaxing by bringing the stunning views and outdoor experience into the fluid living and dining spaces.





*Artist's render for illustration purposes only.

The rapidly changing needs of cosmopolitan living require new approaches to residential design. Taking a dramatically different and innovative strategy to traditional residential design, Haraya Residences reimagines the modern home for a new era.

The generously-appointed master bedroom features a spacious en suite bathroom, a walk-in closet, and large, floor-to-ceiling windows that invite natural light during the day, and frame the beautiful cosmopolitan cityscape at night.



*Artist's render for illustration purposes only.



*Artist's render for illustration purposes only.

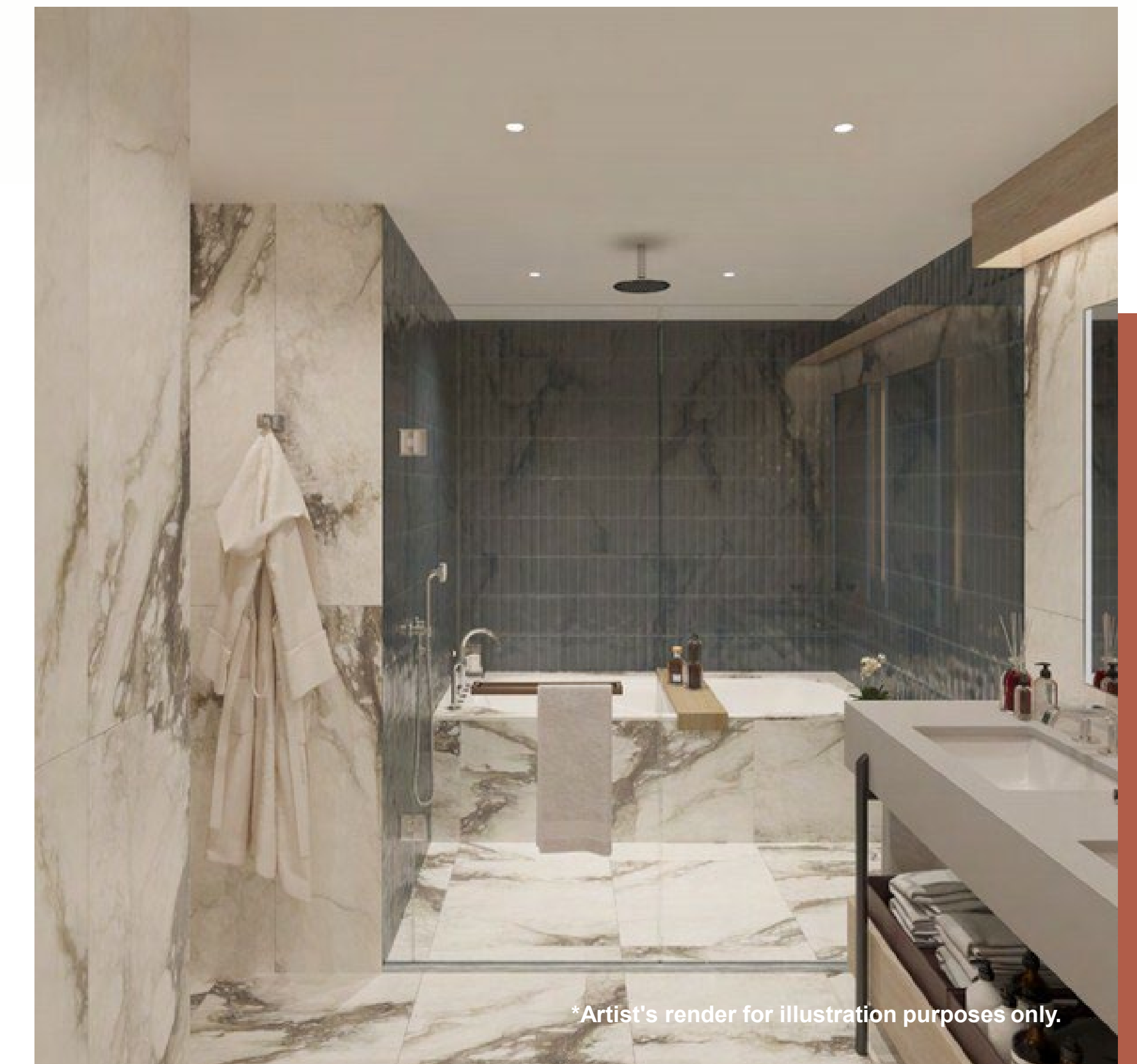

*Artist's render for illustration purposes only.

Two-Bedroom E

Unit size (including loggia): approximately 139 - 140 sqm / 1496 - 1506 sqft

Loggia size: approximately 10 sqm / 107 sqft

- | | |
|----------------------|----------------------|
| 1. Living Room | 7. Secondary Bedroom |
| 2. Dining Room | 8. Kitchen |
| 3. Master Bedroom | 9. Maids Bathroom |
| 4. Walk-in Closet | 10. Maids Room |
| 5. En Suite Bathroom | 11. Loggia |
| 6. Bathroom | |

WD Washer - Dryer

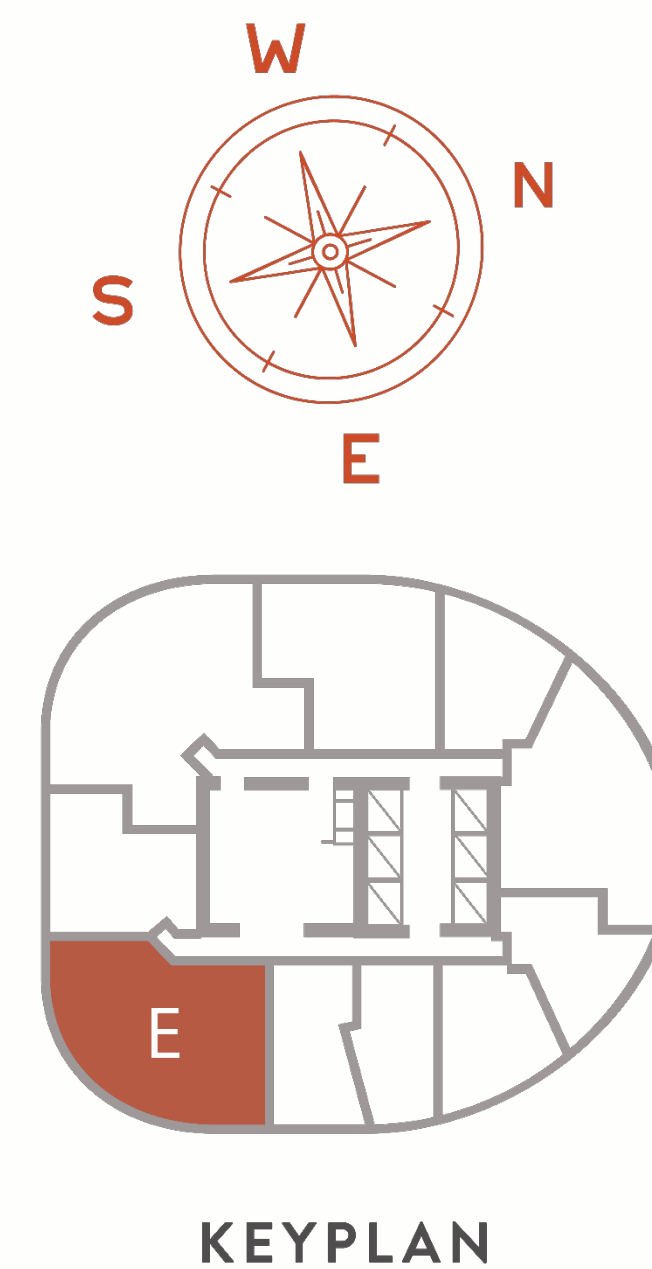
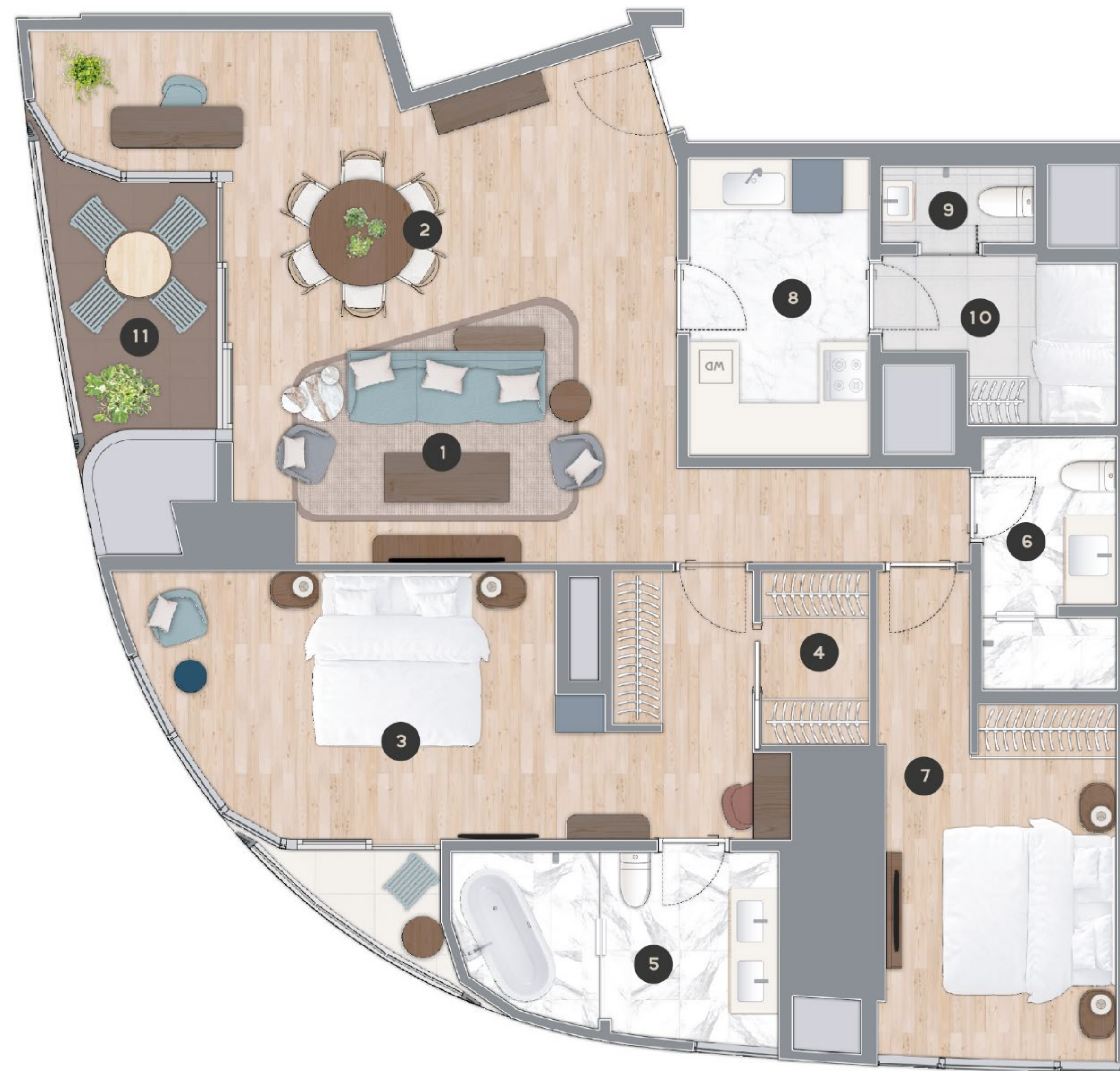

KEYPLAN

*Artist's perspective for illustration purposes only.

Two-Bedroom H

Unit size (including loggia): approximately 107 - 108 sqm / 1151 - 1162 sqft
Loggia size: approximately 7 sqm / 75 sqft

- 1. Living Room
- 2. Dining Room
- 3. Master Bedroom
- 4. Walk-in Closet
- 5. En Suite Bathroom
- 6. Bathroom
- 7. Secondary Bedroom
- 8. Kitchen
- 9. Maids Bathroom
- 10. Maids Room
- 11. Loggia

WD Washer - Dryer

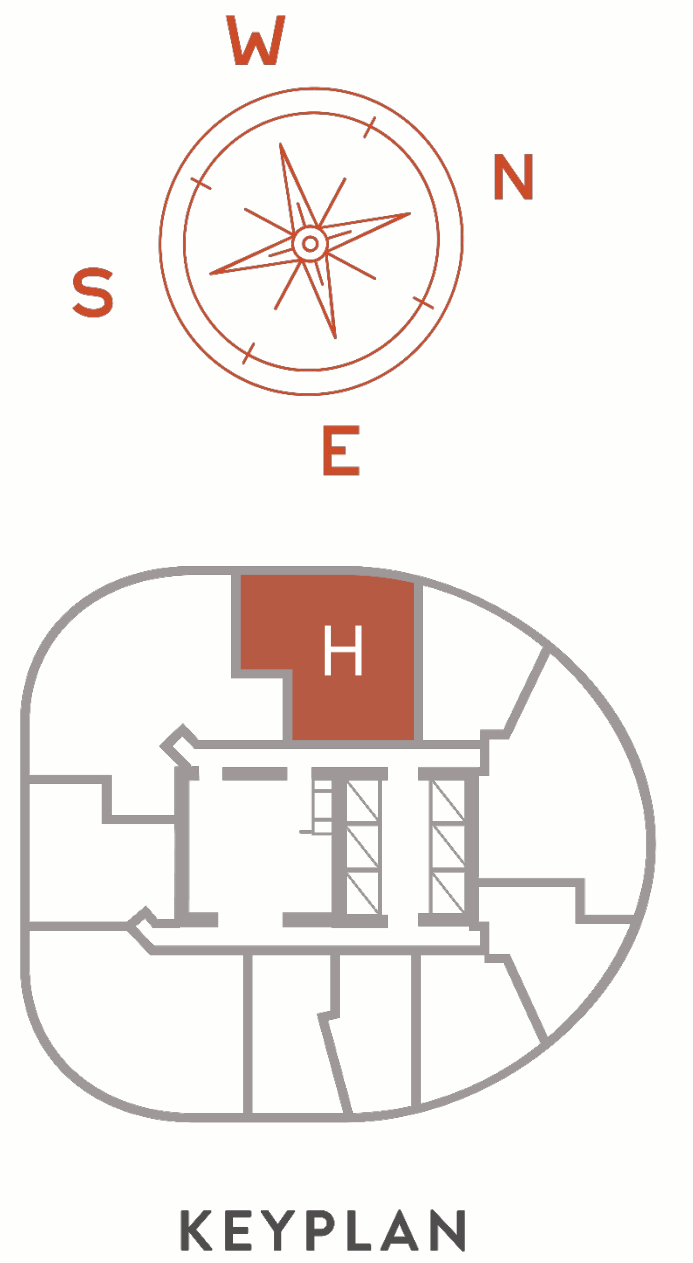

*Artist's perspective for illustration purposes only.

Two-Bedroom J

Unit size (including loggia): approximately 141 - 142 sqm / 517 - 1528 sqft
Loggia size: approximately 9 sqm / 96 sqft

- 1. Living Room
- 2. Dining Room
- 3. Master Bedroom
- 4. Walk-in Closet
- 5. En Suite Bathroom
- 6. Bathroom
- 7. Secondary Bedroom
- 8. Kitchen
- 9. Maids Bathroom
- 10. Maids Room
- 11. Loggia

WD Washer - Dryer

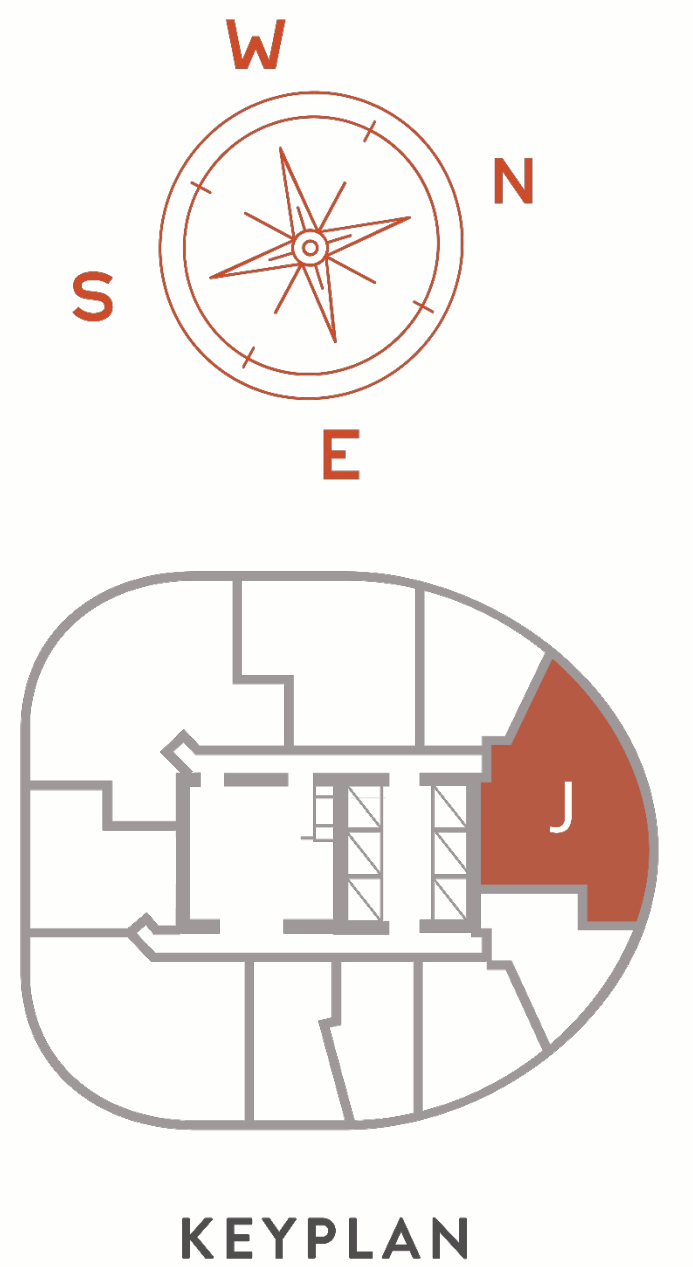

*Artist's perspective for illustration purposes only.

The Three-Bedroom Unit (G)

The Three-Bedroom Unit represents the full expression of our unique al fresco design vision—where interior spaces merge seamlessly with the outdoors through loggias—inviting you to step outside and into the heart of your home.

Designed for families and those seeking the luxury of space, The Three-Bedroom Unit is an exquisite balance of private and entertainment areas, offering sweeping views from residence.



*Artist's render for illustration purposes only.



*Artist's render for illustration purposes only.

Step through the floor to ceiling sliding doors into a fluid outdoor terrace space connected to the living and dining areas as well as the master bedroom terrace. Discover a new sense of freedom and movement in your home. Return to a sanctuary of calm in the exquisitely appointed master bathroom and beautiful fixtures.



*Artist's render for illustration purposes only.



Three-Bedroom G

Unit size (including loggia): approximately 186 - 187 sqm / 2002 - 2012 sqft

Loggia size: approximately 17 sqm / 182 sqft

- | | |
|----------------------|-----------------------|
| 1. Living Room | 7. Secondary Bedrooms |
| 2. Dining Room | 8. Kitchen |
| 3. Master Bedroom | 9. Maids Bathroom |
| 4. Walk-in Closet | 10. Maids Room |
| 5. En Suite Bathroom | 11. Loggia |
| 6. Bathrooms | 12. Private Lift |

WD Washer - Dryer

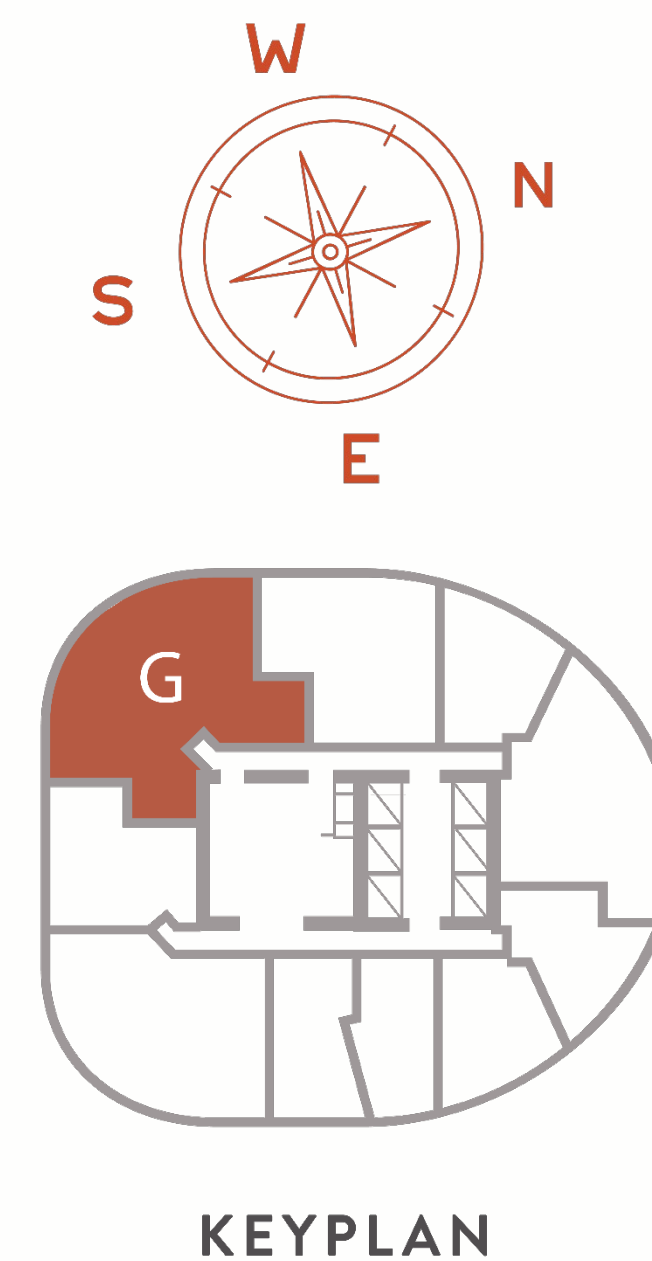

*Artist's perspective for illustration purposes only.

Building floorplan

Haraya Residences Typical Building Plan

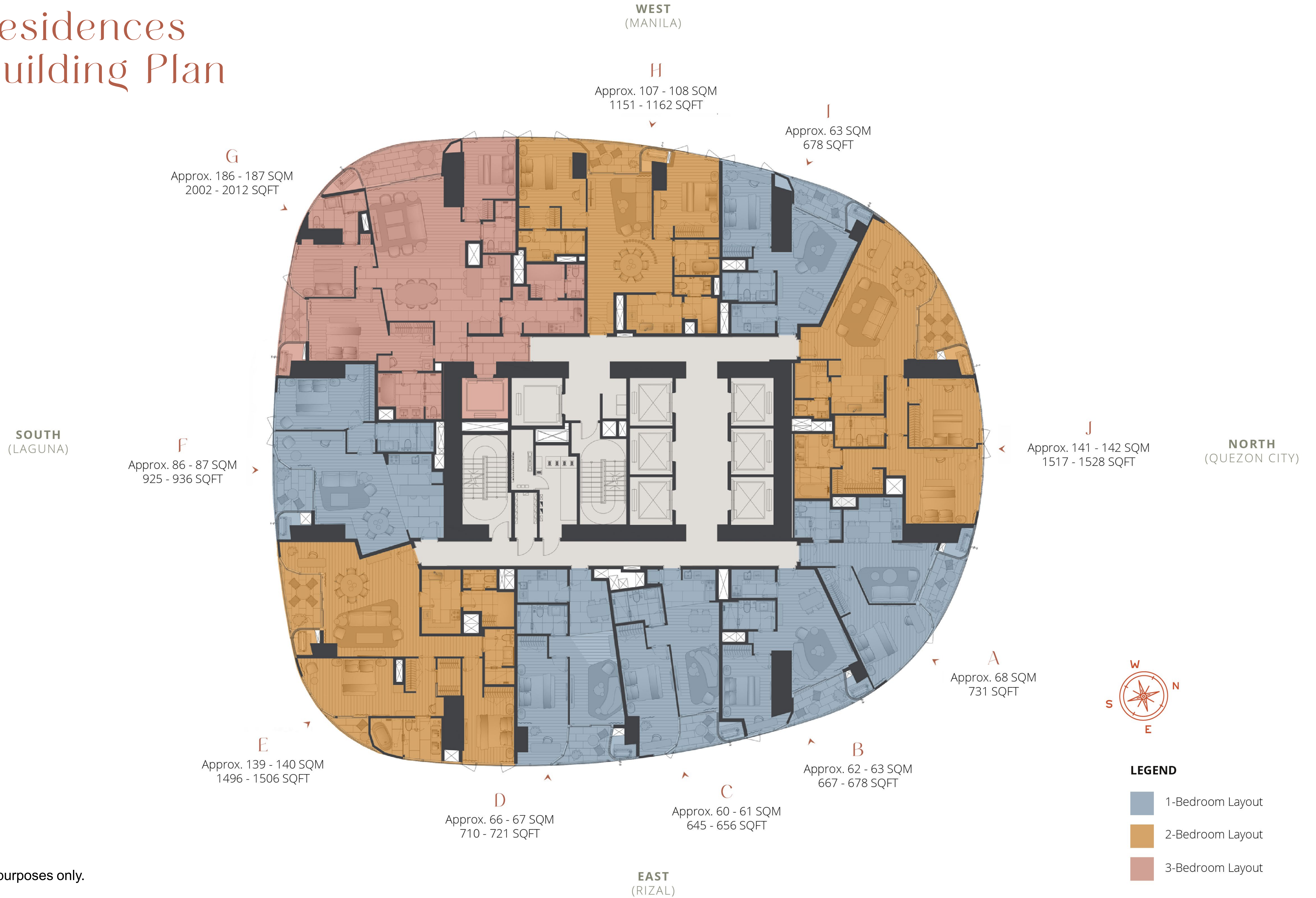

*Artist's perspective for illustration purposes only.

Unit Virtual Tour

Click on a unit to preview.

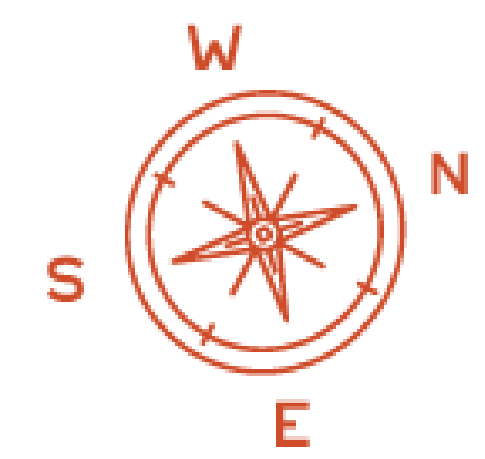
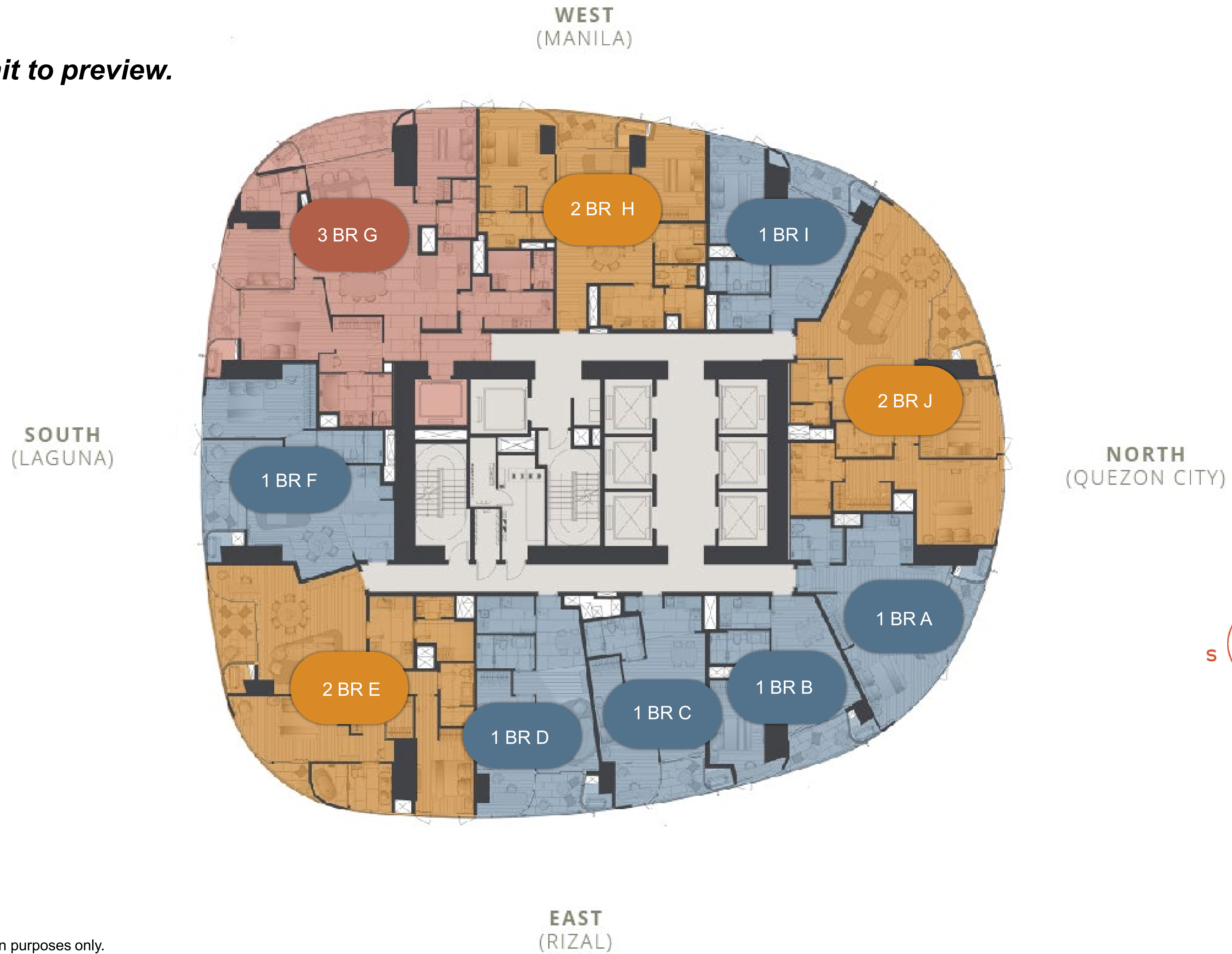

*Artist's perspective for illustration purposes only.

*Artist's render for illustration purposes only

One-Bedroom Unit A North | Quezon City and Marikina Orientation

[Visit 360 Virtual Tour >>](#)

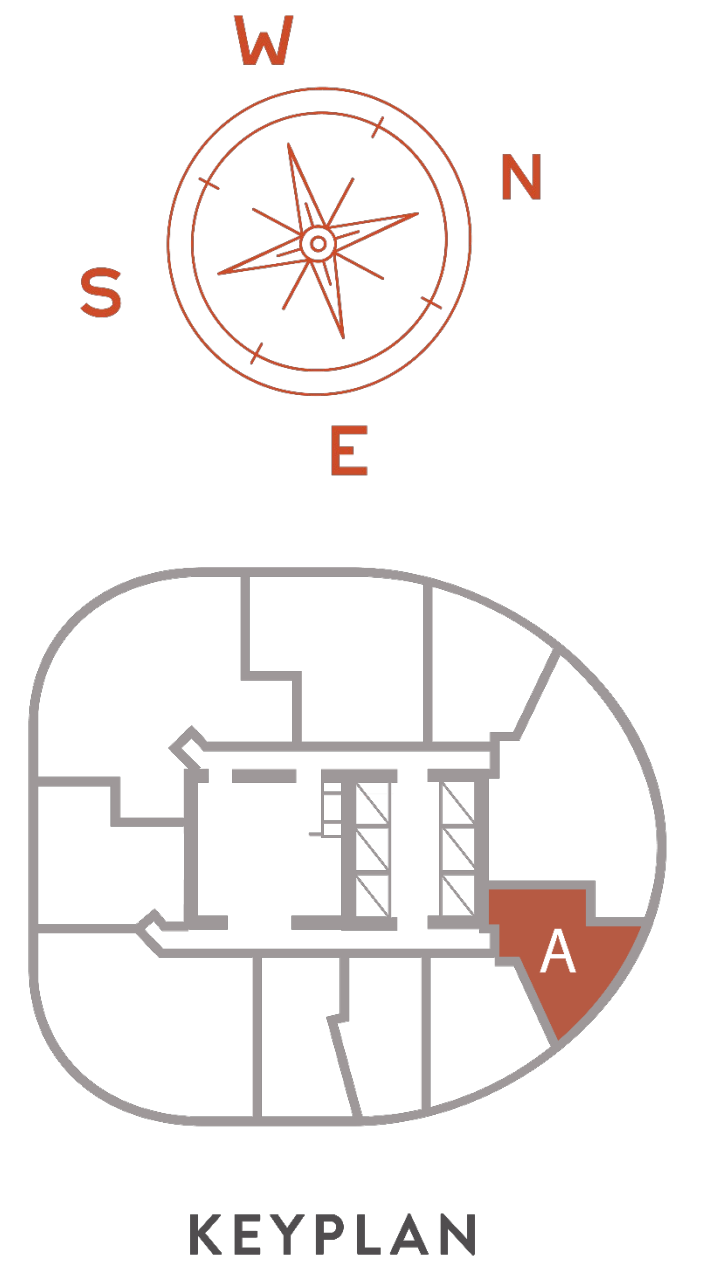

Horizon Line at 200m

[<< Select a different Unit](#)

One-Bedroom Unit B East | Rizal Orientation

[Visit 360 Virtual Tour >>](#)

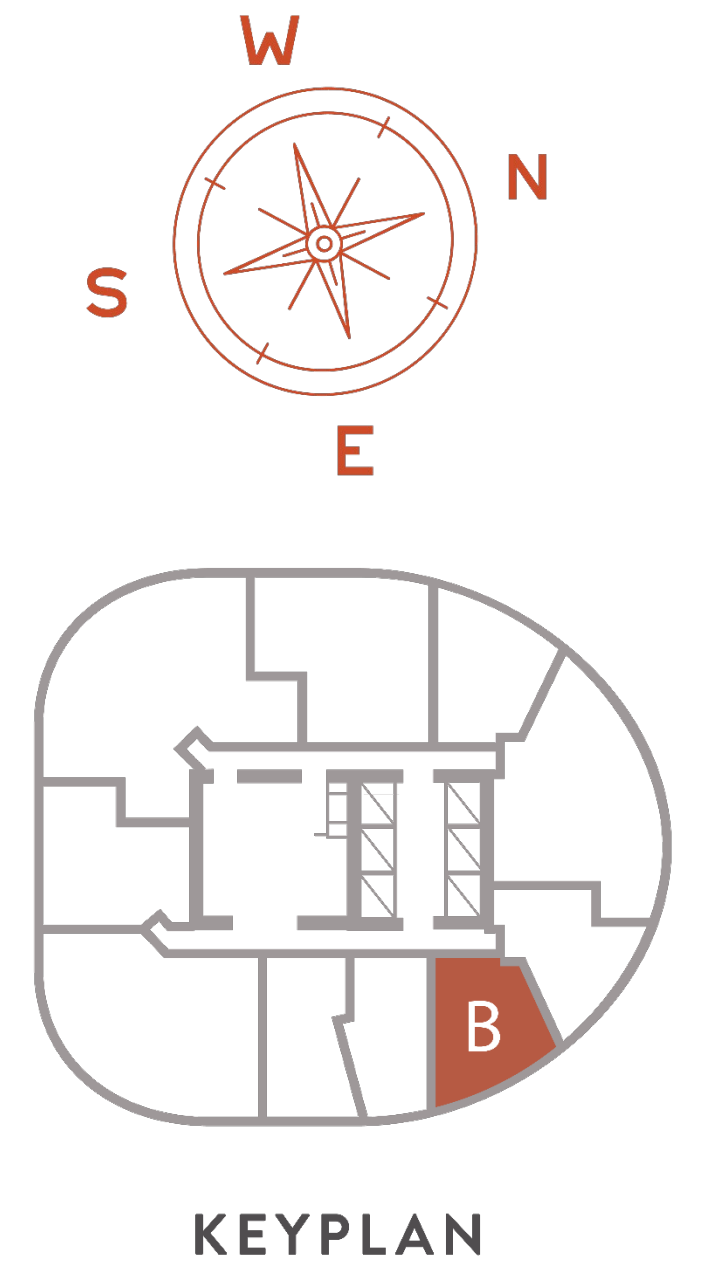

Horizon Line at 200m

[<< Select a different Unit](#)

One-Bedroom Unit C East | Rizal Orientation

[Visit 360 Virtual Tour >>](#)

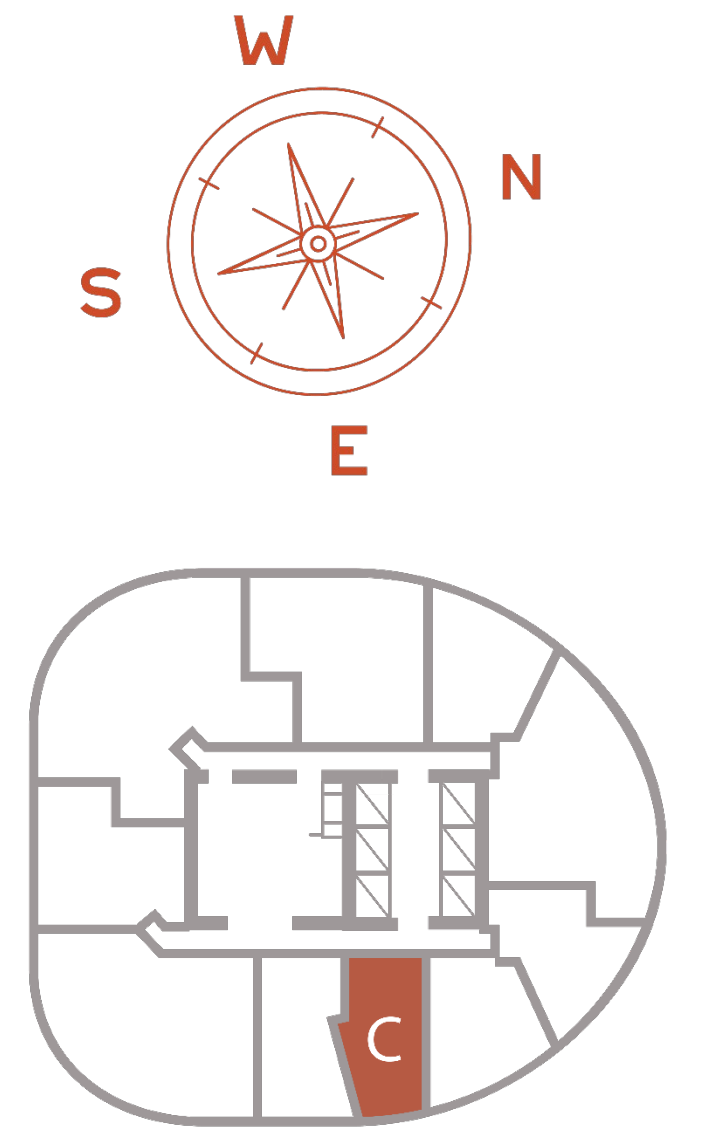

KEYPLAN



Horizon Line at 200m

[<< Select a different Unit](#)

One-Bedroom Unit D East | Rizal Orientation

[Visit 360 Virtual Tour >>](#)

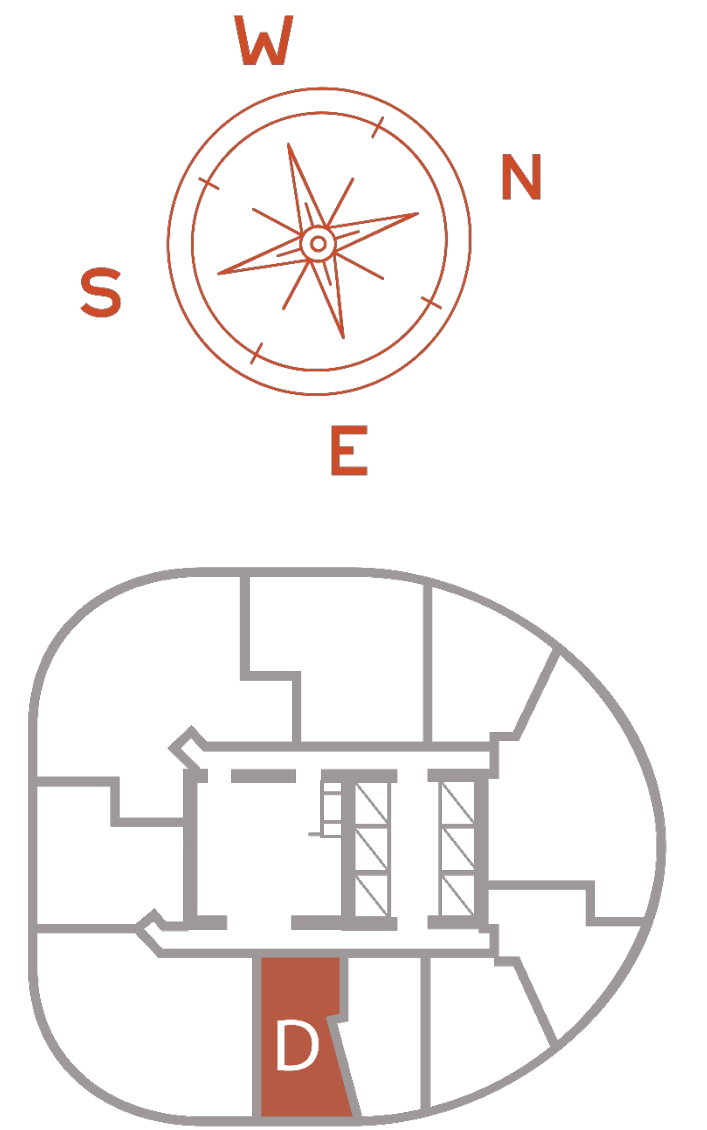

KEYPLAN

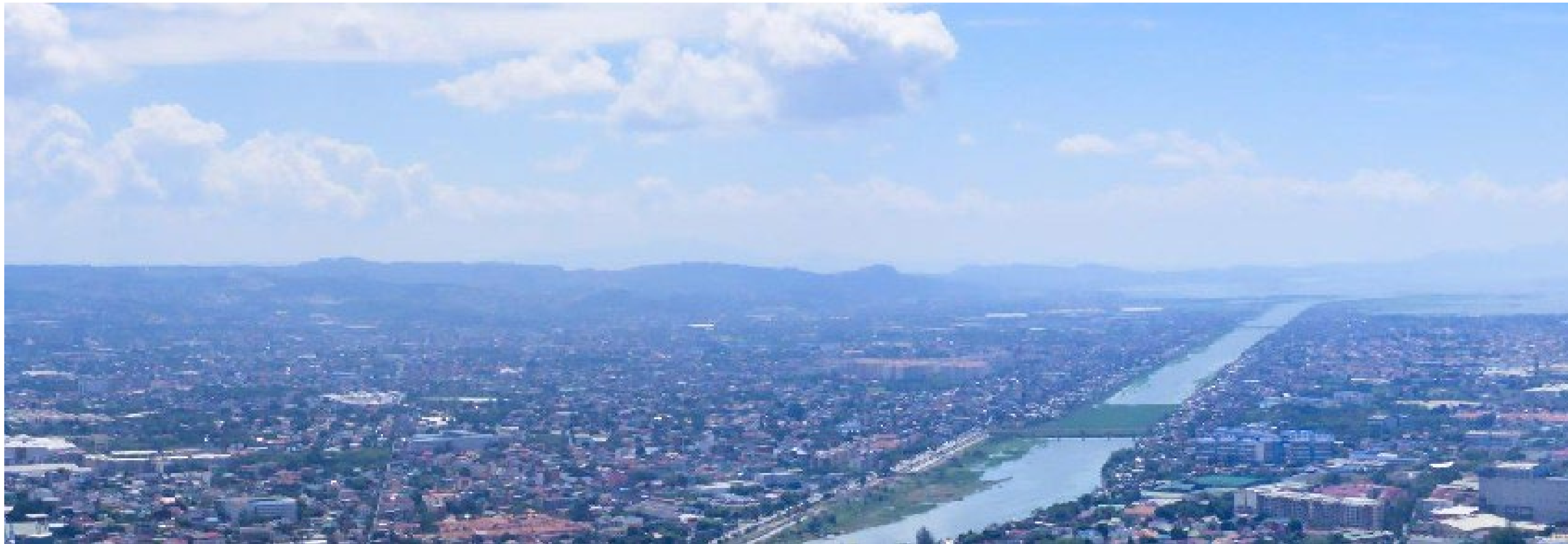

Horizon Line at 200m

[<< Select a different Unit](#)

One-Bedroom Unit F South | BGC Orientation

[Visit 360 Virtual Tour >>](#)

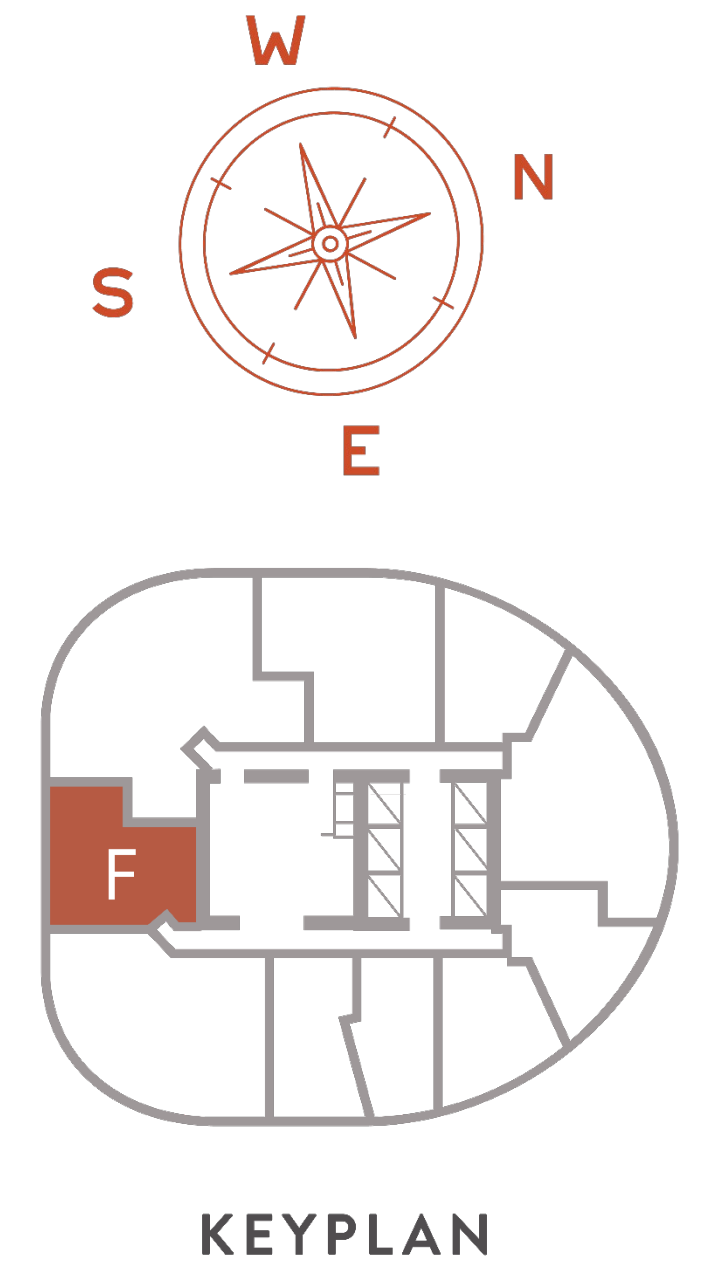

Horizon Line at 200m

[<< Select a different Unit](#)

One-Bedroom Unit I West | Manila Orientation

[Visit 360 Virtual Tour >>](#)

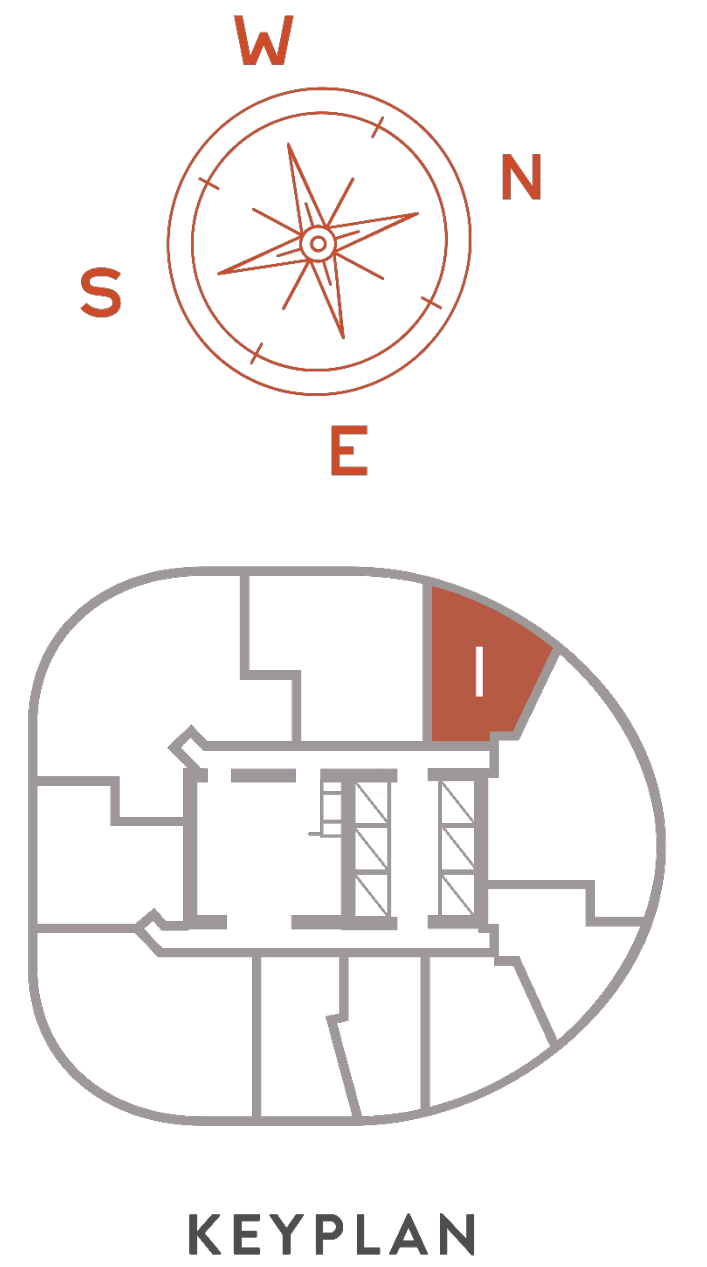

Horizon Line at 200m

[<< Select a different Unit](#)

Two-Bedroom Unit E East | Rizal City Orientation

[Visit 360 Virtual Tour >>](#)

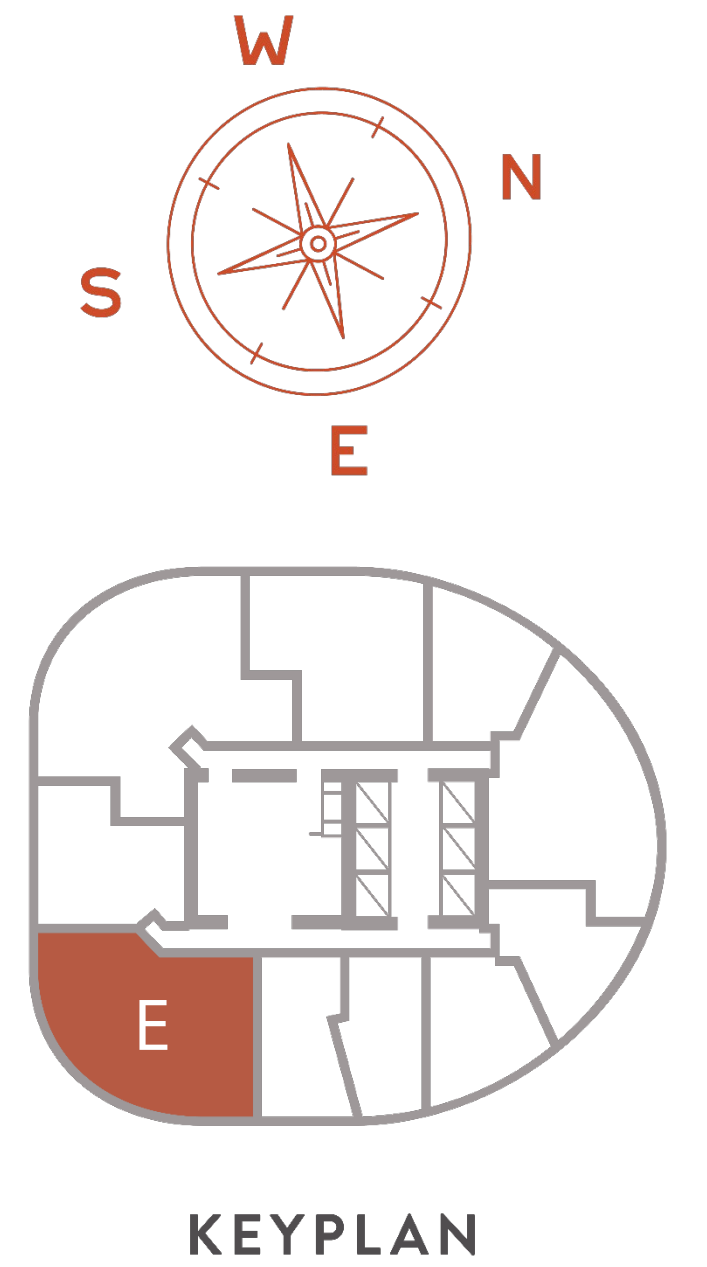

Horizon Line at 200m

[<< Select a different Unit](#)

Two-Bedroom Unit H West | Manila Orientation

[Visit 360 Virtual Tour >>](#)

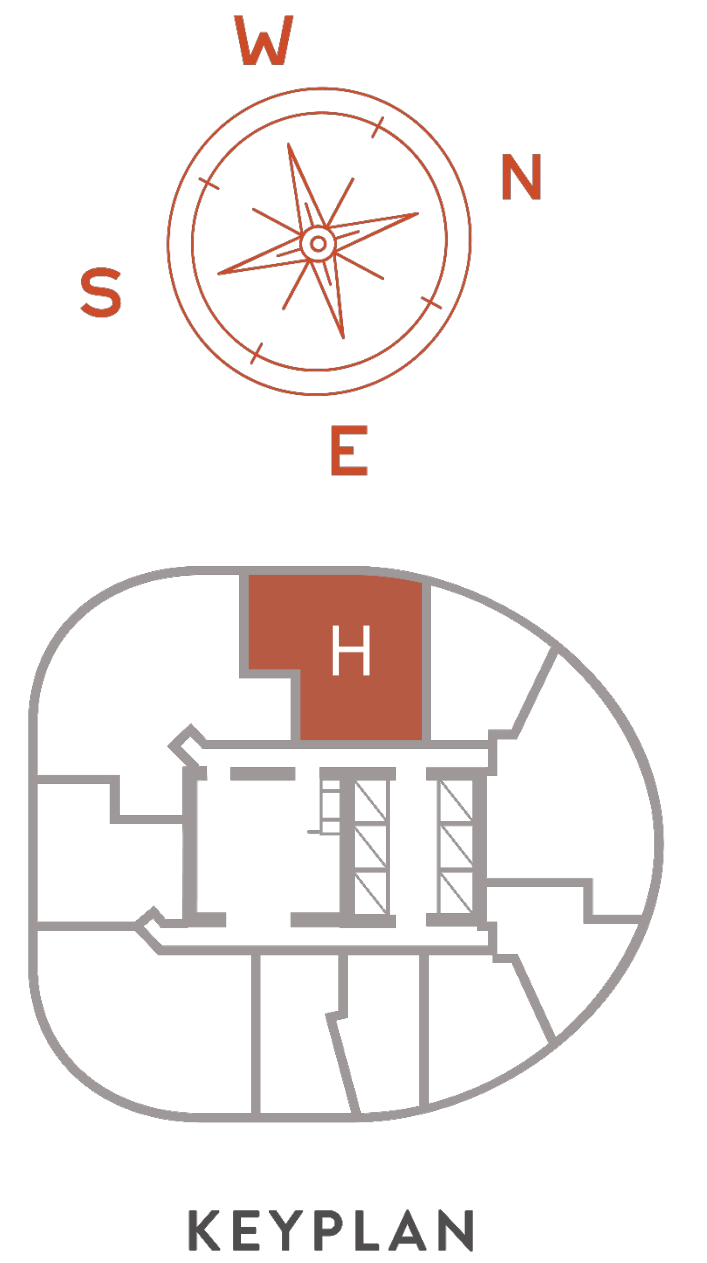

[<< Select a different Unit](#)

Horizon Line at 200m

Two-Bedroom Unit J North | Quezon City Orientation

[Visit 360 Virtual Tour >>](#)

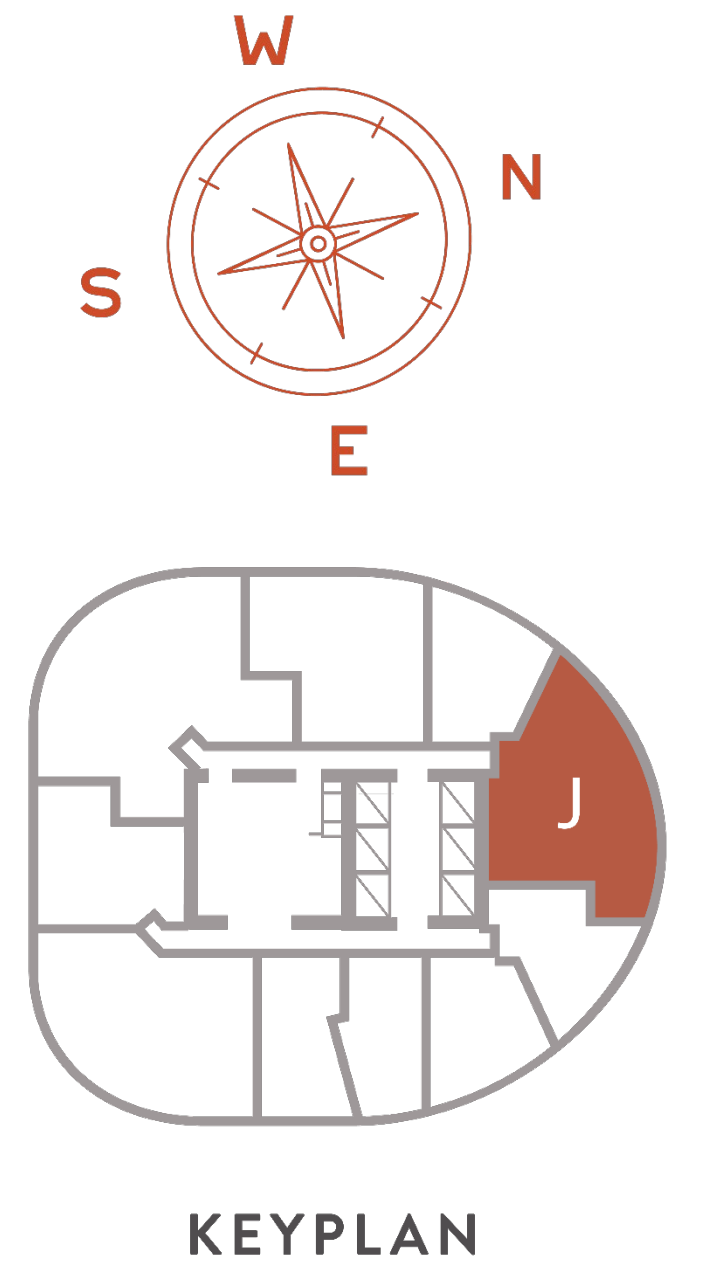

Horizon Line at 200m

[<< Select a different Unit](#)

Three-Bedroom Unit G Southwest | BGC and Manila Orientation

[Visit 360 Virtual Tour >>](#)

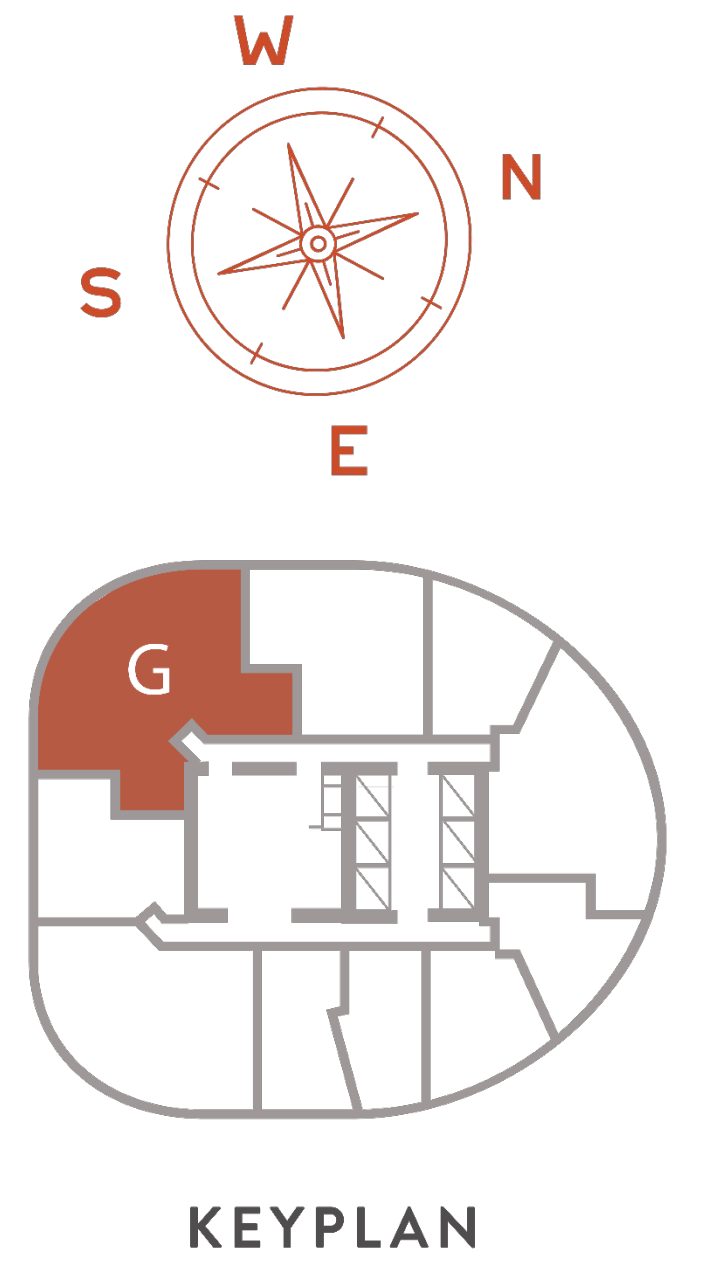

Horizon Line at 200m

[<< Select a different Unit](#)

Handover Provisions

Handover Provisions

ENTRANCE

- Solid core main door with digital lockset

LIVING AND DINING SPACES

- Painted walls and ceiling
- Engineered wood flooring / Porcelain tile flooring*
- Split type air-conditioning units

MASTER AND SECONDARY BEDROOMS

- Engineered wood flooring
- Painted walls and ceiling
- Semi-solid core door
- Wardrobe
- Split type air-conditioning units

MASTER BATHROOM

- Porcelain tile flooring
- Full-height wall tiles
- Natural stone vanity countertop
- Glass shower enclosure
- Toto/ Kohler (or equivalent) bathroom fixtures & fittings
- Multi-point water heater

SECONDARY BATHROOM/S

- Porcelain tile flooring
- Full-height wall tiles
- Quartz stone vanity countertop sink
- Glass shower enclosure
- Toto/ Kohler (or equivalent) bathroom fixtures & fittings
- Multi-point water heater

KITCHEN

- Porcelain tile flooring
- Painted walls and ceiling
- Quartz stone countertop
- Premium kitchen cabinet system
- Stainless steel sink with pullout spray faucet
- Branded appliances: fridge, built-in hood, built-in oven, induction cook top
- Single-point water heater
- Combination washer and dryer (1-bedroom and 2-bedroom units)
- Separate washer and dryer (3-bedroom and penthouse units)

MAIDS ROOM

- Porcelain tile flooring
- Painted walls and ceiling

MAIDS BATHROOM

- Porcelain tile flooring
- Ceramic tile wall
- Bathroom sink, shower, and water closet

BALCONY

- Porcelain tile flooring

OTHER PROVISIONS

- Dedicated water and electricity meters
- Telephone / data provision
- Cable TV provision
- Intercom system

**depending on unit configuration*



*Artist's render for illustration purposes only

The Team Behind Haraya Residences

P & T Group CONCEPT ARCHITECT

P&T Group is the oldest and largest international architectural engineering practice in Southeast Asia, providing clients with innovative, commercially successful and sustainable design solutions since its inception in 1868.

The award-winning global design firm, with over 1600 architects, engineers, urban designers, and interior designers, operate in over 70 cities, on an excess of 10 million square meters of combined floor area, and is consistently ranked in the top largest consultancies in the world.



*Artist's render for illustration purposes only

The Team Behind Haraya Residences

FM Architettura CONCEPT INTERIOR DESIGNER

FM Architettura is a world leader in the field of interior design, headquartered in Camerano, Italy. Founded in 2010, the firm is renowned for an unwavering commitment to craftsmanship, attention to detail, and comprehensive research and innovation in its work.

FM Architettura has delivered over 150 one-of-a-kind projects around the world, ranging from bespoke superyachts and private mansions, to high-end residential towers, iconic luxury hotels, and more.



*Artist's render for illustration purposes only

The Team Behind Haraya Residences

P Landscape

CONCEPT LANDSCAPE ARCHITECT

P Landscape is a landscape architecture and design studio based in Bangkok, Thailand. PLA began as a boutique landscape design practice in 1997, and has since blossomed into an association of creative and talented individuals encompassing landscape architects, designers, horticulturalists, and artists.

PLA specializes in high-end resort, hotel, and residential projects, both in the Southeast Asian region and worldwide, including projects in China, India, the Middle East, the Maldives, and the Fiji Islands.



*Artist's render for illustration purposes only

Consultants

Architect of Record
Lighting Consultant
Structural Engineering Consultant
Electrical Engineering Consultant

Mechanical Engineering Consultant
Plumbing Engineering Consultant
Elevator Consultant
Façade Engineering

Casas + Architects, Inc.
Worktecht Corporation (HK) Limited
Sy^2 + Associates, inc.
A. Licerio, Evangelista, Conception, Siva, Solis
Contractors Inc. (ALECS)
Isagani M. Martinez Consulting Engineer (IMMCE)
FL Figueroa & Associates (FLFA)
Roy Barry & Associates
ALT Cladding, Inc.

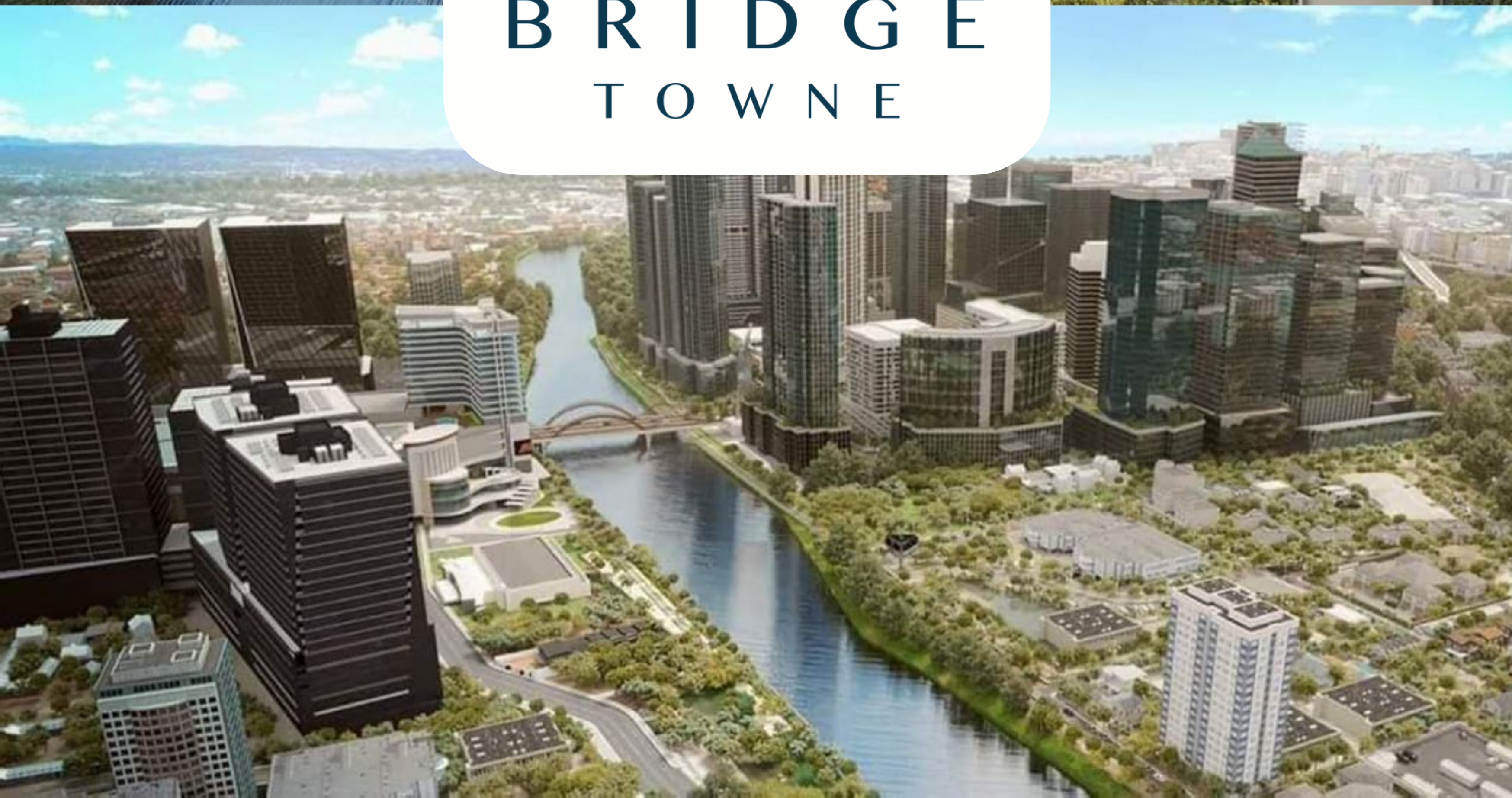

About

Bridgetowne is a real estate development spanning the border of Pasig and Quezon City in Metro Manila. It is a mixed township and business park situated in a former industrial area on both banks of the Marikina River near the junction of Eulogio Rodriguez Jr. Avenue (C-5 Road) and Ortigas Avenue. The 30 hectare master planned community is the first integrated township project by Robinsons Land Corporation.

Existing Developments

1. Zeta Tower

- 20-storey LEED Silver Certified Bldg.
- 14 office floors
- 4 Podium and 1Basement Parking Floors
- 2 Floors of Retail and Services

2. Exxa Tower

- 20-storey LEED Silver Certified Bldg.
- 14 office floors
- 4 Podium and 1Basement Parking Floors
- 2 Floors of Retail and Services

3. Tera Tower

- 20-storey LEED Gold Certified Bldg.
- 15 office floors
- 4 Podium and 1Basement Parking Floors
- Ground Floor Retail

4. Giga Tower

- 28-storey PEZA Registered Bldg.
- 21 office floors
- 6 Podium and 2 Basement Parking Floors
- Ground Floor Retail

5. Blue Leaf Cosmopolitan

- Up to 1,000 pax capacity
- 3 Events Hall with up to 350 pax capacity

6. Velaris Showroom

7. Meralco Power Substation

- One of the largest Gas Insulated Switchgear
- Initial capacity of 83 MVA



Gokongwei Brothers Foundation Towers



GBF Tower 1

±55,000 sqm. GFA

29 Floors

Start of Construction – Q4 2019

End of Construction – Q1 2022

GBF Tower 2

±60,000 sqm. GFA

29 Floors

Start of Construction – Q4 2021

End of Construction. – Q4 2022

Total Lot Area – 6,921 sqm.



Robinsons Doubledragon Square



RDDS Tower A

±43,000 sqm GFA

25 Floors

Target Start of Construction – Q3 2021

Target End of Construction. – Q2 2024

RDDS Tower B

± 33,000 sqm GFA

22 Floors

Total Lot Area – 5,370 sqm.

Opus

154,000 sqm Gross Floor Area
1,791 Parking Slots
5,000 sqm Food Hall
5 Levels of Retail + Roof Deck
5 Levels of Parking



The Bridge



The Victor



The Central Park



The Promenade



Ferry Station

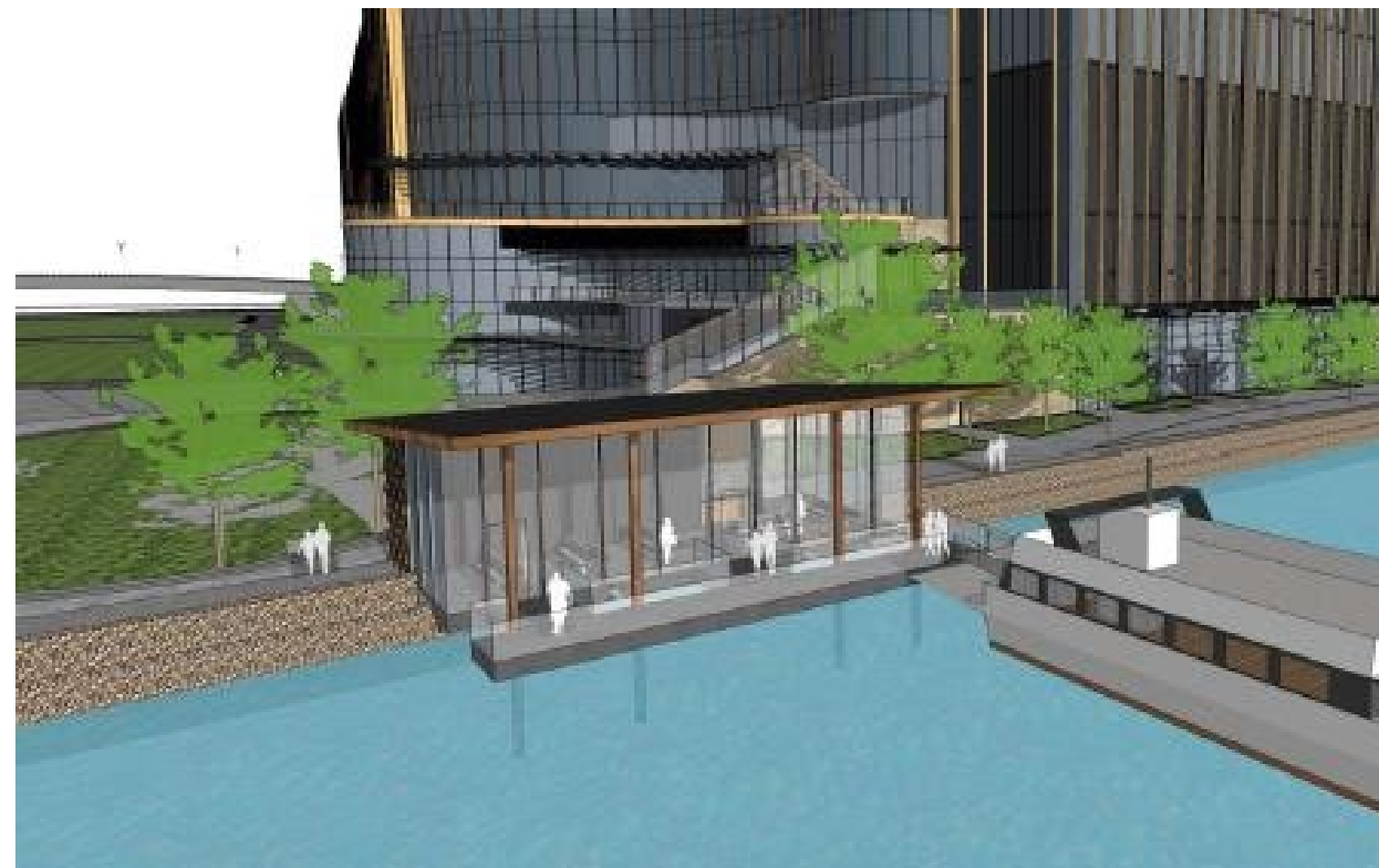

Behind the development

Haraya Residences is brought to you by Shang Robinsons Properties, Inc. (SRPI), a joint venture between Shang Properties, Inc. and Robinsons Land Corporation. Aurelia Residences in Bonifacio Global City is another signature development of SRPI.

Haraya Residences joins Shang Properties' other luxury developments such as The Shang Grand Tower, Shang Salcedo Place, The St. Francis Shangri-La Place, One Shangri-La Place, Shang Residences at Wack Wack, and Horizon Homes at Shangri-La at the Fort, and Robinsons Land Corporation's The Residences at Westin Manila Sonata Place.



Experience Haraya Residences

Haraya Residences Sales Gallery and Sales Office

Address: Riverside Road corner Bridgetowne Blvd., Bridgetowne Destination Estate, E. Rodriguez Ave., Brgy. Rosario, Pasig City
Website: www.harayaresidences.com
Email: sales@harayaresidences.com
Mobile: 0917 5-HARAYA 427292
Telephone: (+632) 5-318-7200

DHSUD Provisional License to Sell No. 489

Date Issued: 11 / 3 / 2022

Project Completion: South Tower: 31 July 2028

Project Location: Riverside Road corner Bridgetowne Blvd., Bridgetowne Destination Estate, E. Rodriguez Ave., Brgy. Rosario, Pasig City
Developer: Shang Robinsons Properties, Inc.
Land Owner: Robinsons Land Corp.

